

# Projector fixed to the projector beam

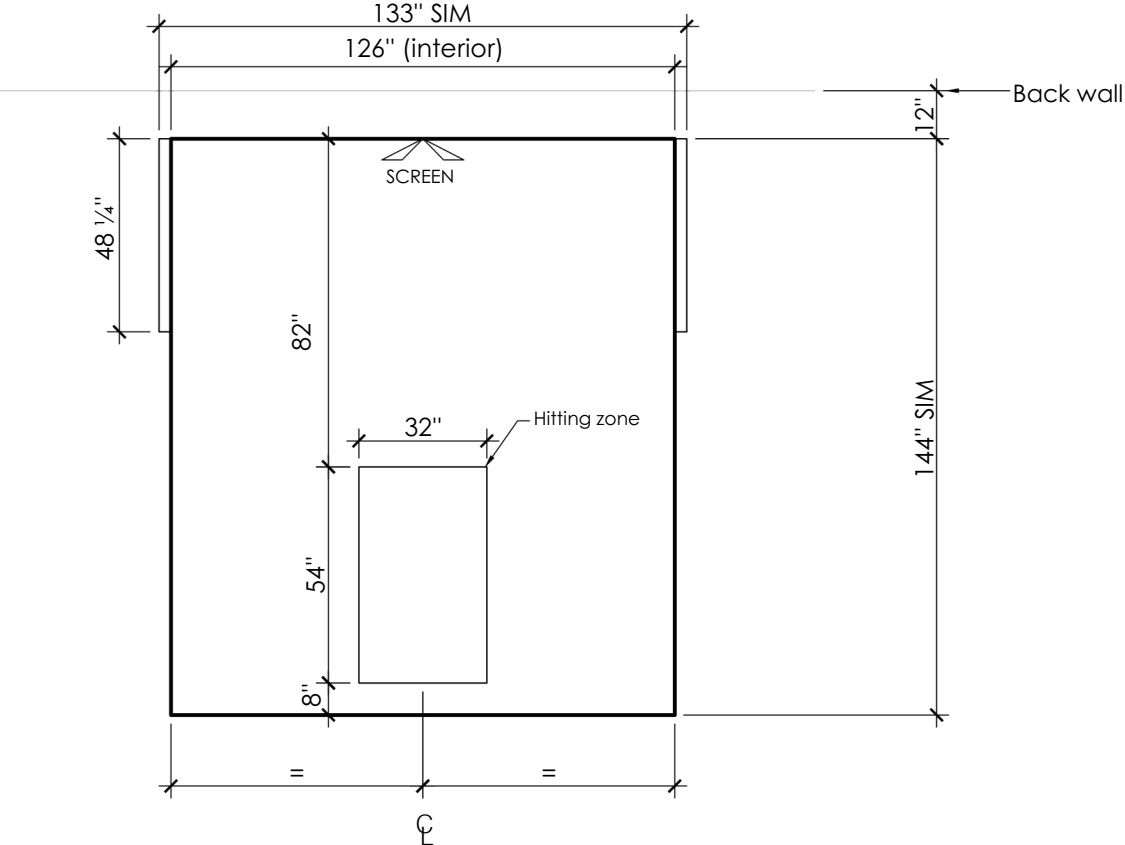

1 TOP VIEW  
SCALE: 1/4" = 1'-0"

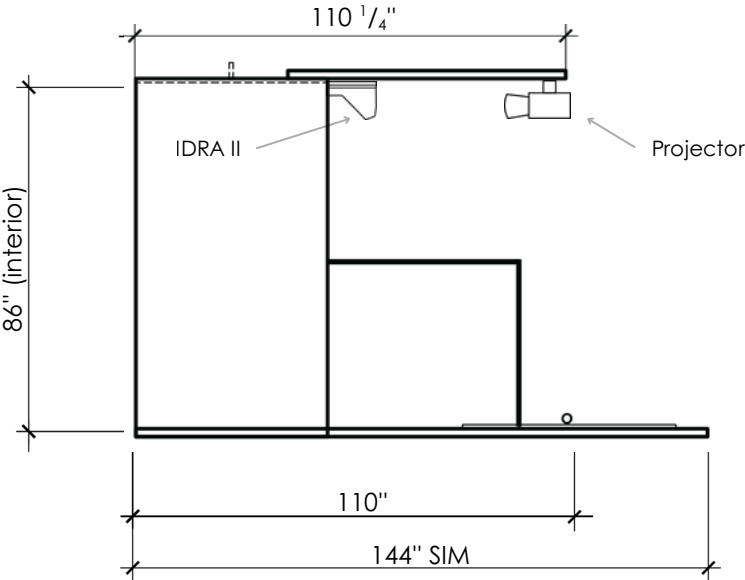

2 SIDE VIEW  
SCALE: 1/4" = 1'-0"

# Projector fixed to the ceiling

(Full-screen projection is only available when IDRA II is fixed on the elevating bracket)

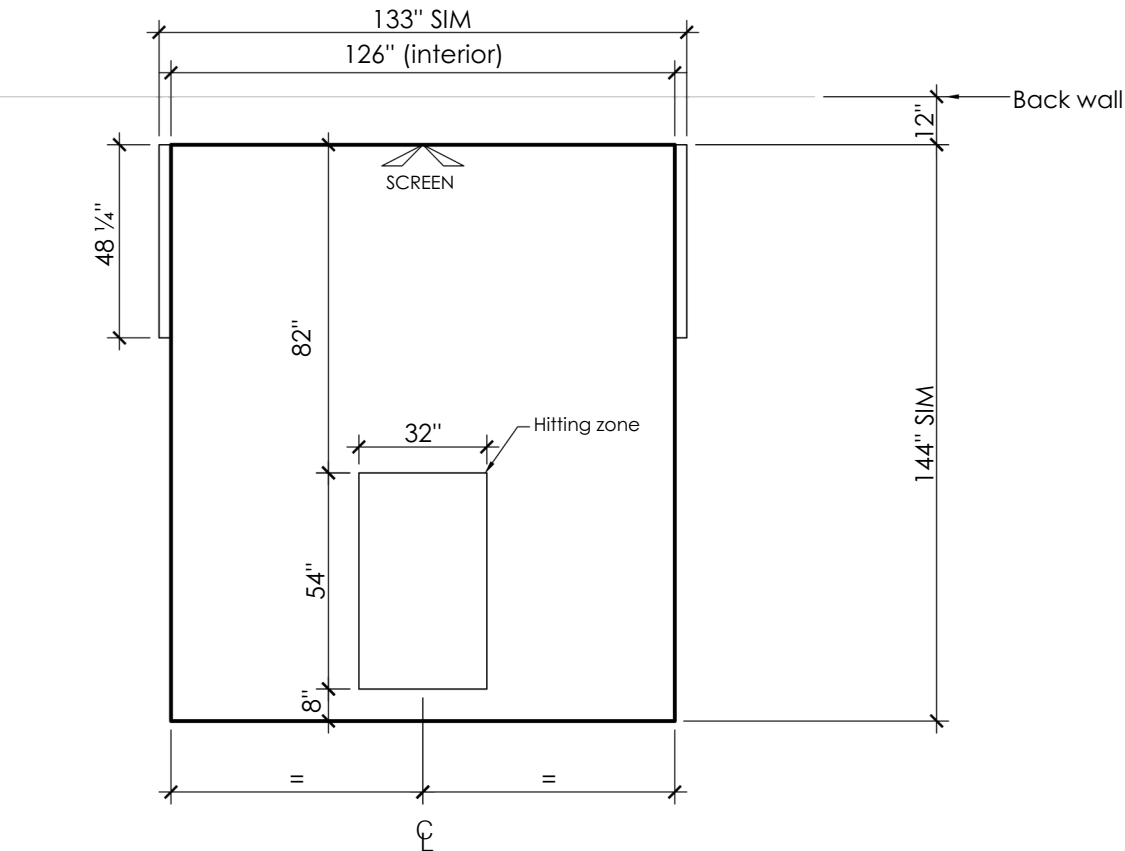

1 TOP VIEW  
SCALE: 1/4" = 1'-0"

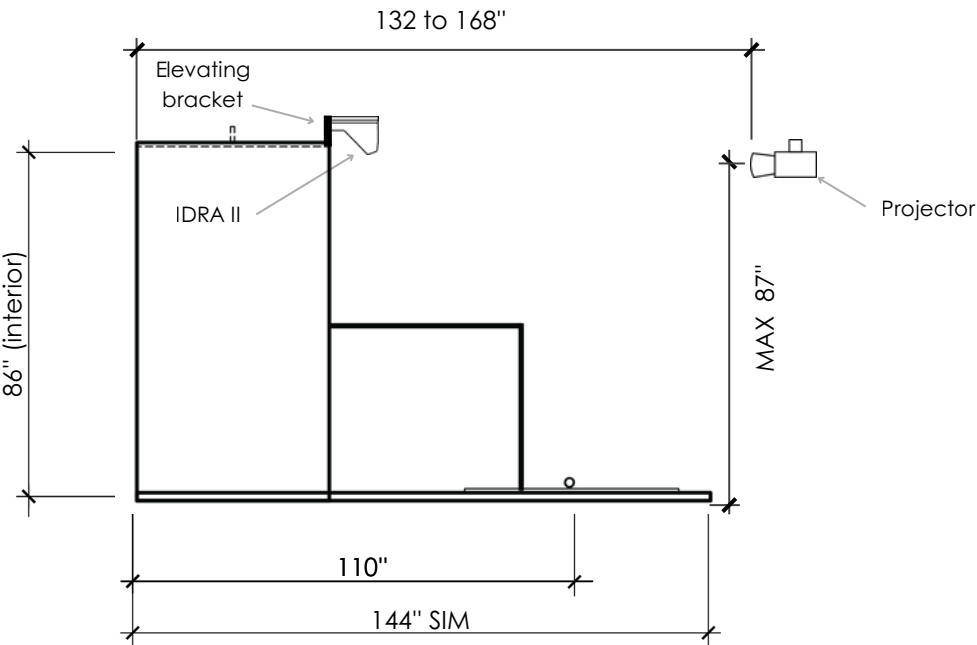

2 SIDE VIEW  
SCALE: 1/4" = 1'-0"