



INSTALLATION GUIDE

SIMBOOTH KIT 2 - 4K

TABLE OF CONTENTS

Important information	1
PC specifications	2
Parts list	3-4
Structure installation	5-9
Floor installation	10-11
Half walls installation	11
Electronics installation	12
Cable connections	13-14
IDRA II installation	15
Appendix A	16
Appendix B	17-20
Appendix C	21-24



**WARNING**

PLEASE READ THE FOLLOWING BEFORE USE.

FAILURE TO FOLLOW THE INSTRUCTIONS COULD RESULT IN SERIOUS INJURY, PROPERTY DAMAGE, AND/OR VOID THE DEVICE WARRANTY.

- 1.** Do NOT install IDRA II in a location where its operating temperature may be exceeded. Excessive temperatures may damage the launch monitor. Recommended operating temperature range is 0°C – 50°C (32°F – 122°F).
- 2.** Install IDRA II in a room free of excessive dust and humidity to prevent the lens or optical components of IDRA II from becoming clouded or dirty. The recommended humidity level for the room is 30 to 65%.
- 3.** Do NOT attempt to disassemble, repair, or modify IDRA II. Doing so may result in fire, electrical shock, or injury. Contact our support team if any problems occur with the launch monitor.
- 4.** Make sure the hitting zone is not located in direct sun exposure.
- 5.** Be aware of your surroundings and use cautiously with children around.
- 6.** Do NOT install IDRA II outside. This device is only designed for indoor use.
- 7.** Do NOT touch the LED light as it may cause burns, and avoid looking directly at the light to prevent potential eye damage.

PC SPECIFICATIONS WITH GSPRO

Requirement	Minimum	Recommended
Processor	Intel Core i7, 10th Gen, with at least 16 logical processors	Intel Core i7, 10th Gen or newer, with at least 24 logical processors
Storage	512 GB	1 TB
GPU	Nvidia GeForce RTX 20 series	Nvidia GeForce RTX 40 series or newer
RAM memory	16 GB	32 GB
USB Ports	2 USB 3.0 & 1 USB-C ports are required	
Internet	High-speed Internet is required	

PC SPECIFICATIONS WITH E6 CONNECT

Requirement	Minimum	Recommended
Processor	Intel Core i7, 10th Gen or newer, with at least 16 logical processors	
Storage	512 GB	
GPU	Nvidia GeForce RTX 20 series	Nvidia GeForce RTX 30 series or newer
RAM memory	16 GB	
USB Ports	2 USB 3.0 & 1 USB-C ports are required	
Internet	High-speed Internet is required	



WARNING

AMD PROCESSORS ARE NOT SUPPORTED.

DO NOT USE USB CABLE EXTENSION BETWEEN YOUR PC AND YOUR IDRA II.

PARTS LIST

WALL PANELS

RIGHT WALLS



LEFT WALLS



FLOOR PANELS

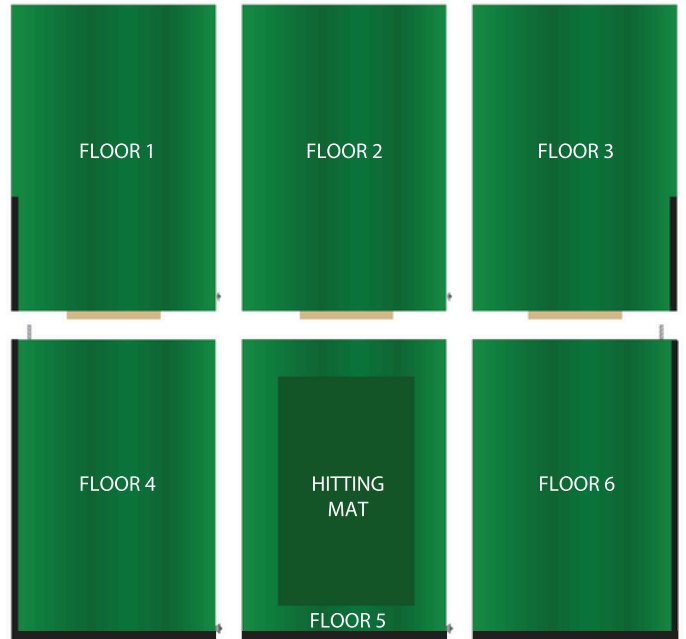

CEILING PANELS

BACK CEILINGS



FRONT CEILINGS



PARTS LIST

ACCESSORIES

Bolts full threads



3-1/2" (10x)

Wing Nuts (4x)



Washer (42x)



Nuts (32x)



Hitting mat



Black impact screen



Bolt



2" (4x)

Scissor bar (2x)



Projector and remote



White screen



Tees (10x)



Half wall (2x)

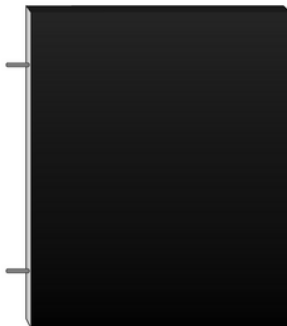

Projector beam



Wire Cover



LAUNCH MONITOR

IDRA II AI launch monitor



With power cable and two
USB camera cables (1x)

Calibration board (1x)

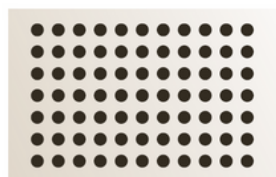

Nuts + Washers
(2x)



USB Hub (1x)



Wireless remotely
operated switch (1x)
(Only included in North America)



For illustration purposes only. Model may vary.

END OF PARTS LIST

BEFORE STARTING

You will need 4 people, 2 ladders, a screwdriver and 1/2 wrench.

1

Fix the left top wall to the left front ceiling with the nuts.

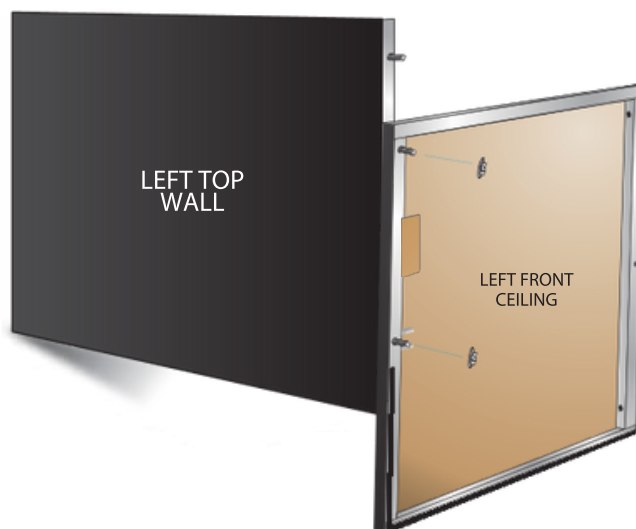

2

Using the nuts, fix the middle front ceiling to the left front ceiling, then fix the right front ceiling to the middle front ceiling.

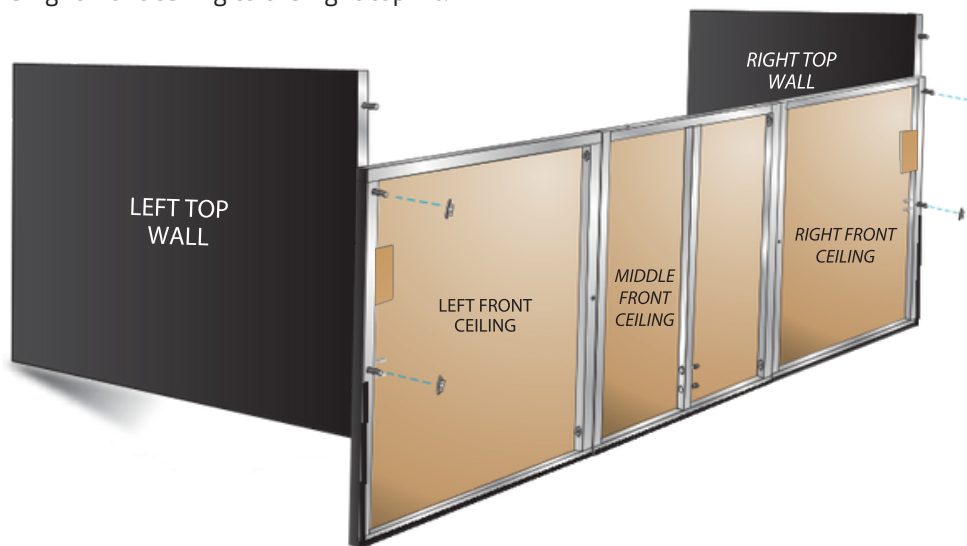

3

Using the nuts, fix the right front ceiling to the right top wall.



4

Fix both bottom wall panels to the top wall panels with the nuts by removing the bottom wall covers (velcro).



5

Fix the left back ceiling to the left top wall with the nuts.



6

Using the nuts, fix the middle back ceiling to the left back ceiling and fix the two middle ceilings together.

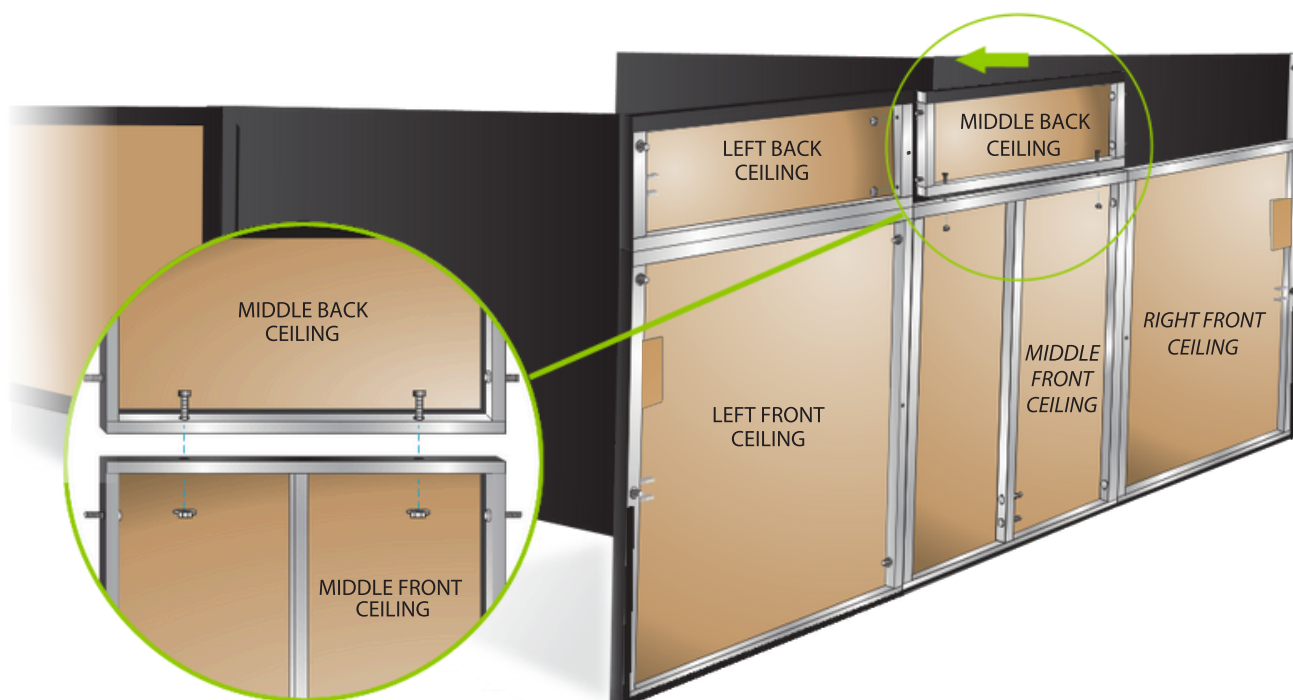

7

Fix the right back ceiling to the middle back ceiling and to the right top wall with the nuts.



8

CEILING TRUSS INSTALLATION

Assemble the scissor bars with bolts and security pins, then insert them in the back ceiling and the front ceiling.

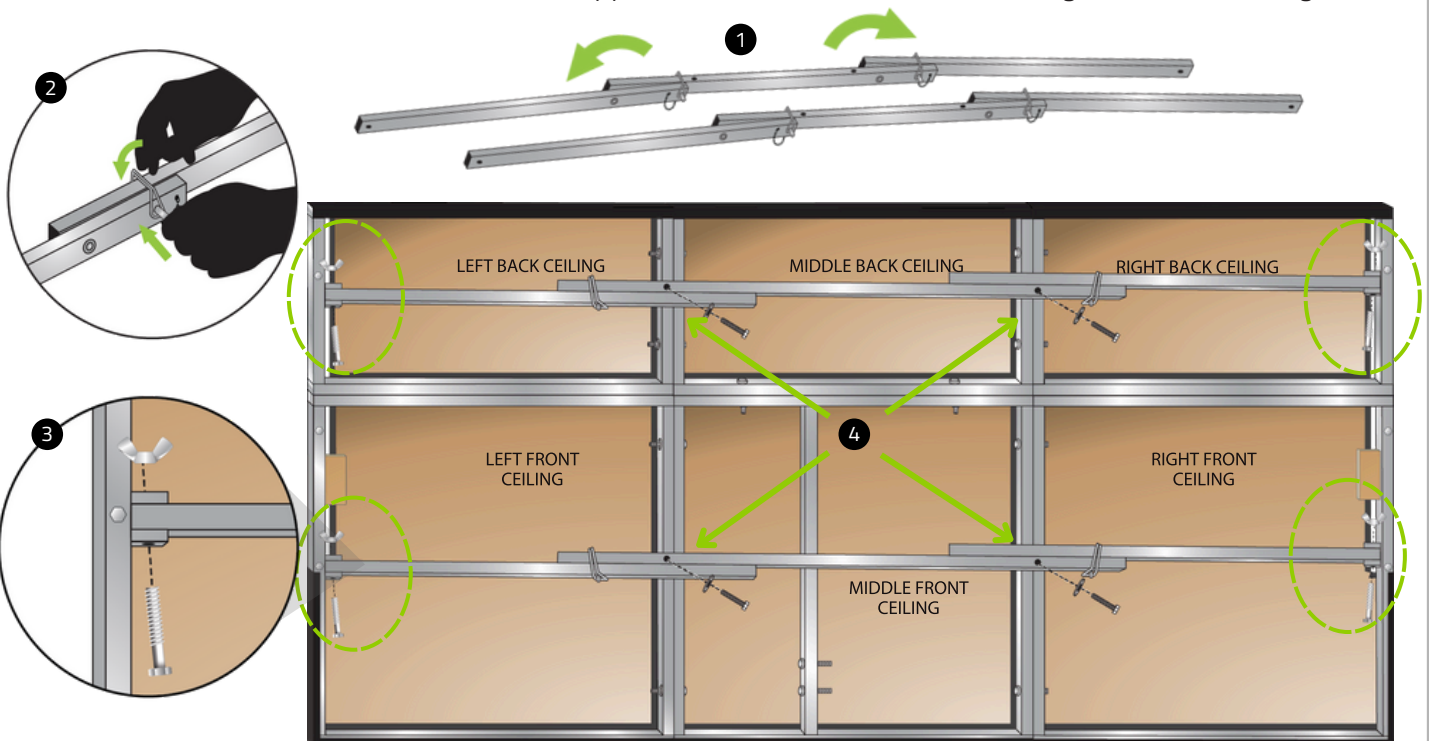

IT IS IMPORTANT TO COMPLETE THIS STEP BEFORE LIFTING THE STRUCTURE.

9

Attach the white screen to the structure.



10

Attach the black netting over the white screen. Make sure it is attached to the top velcro on the ceiling panels and that the bottom doesn't rest on the floor.

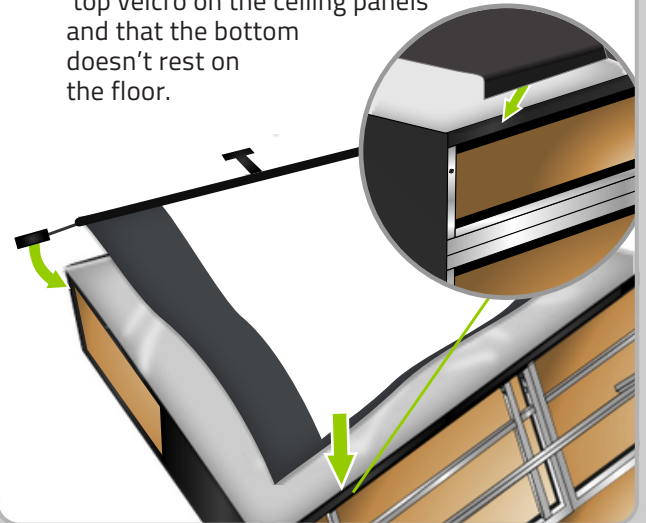

11

Lift the structure with four people.

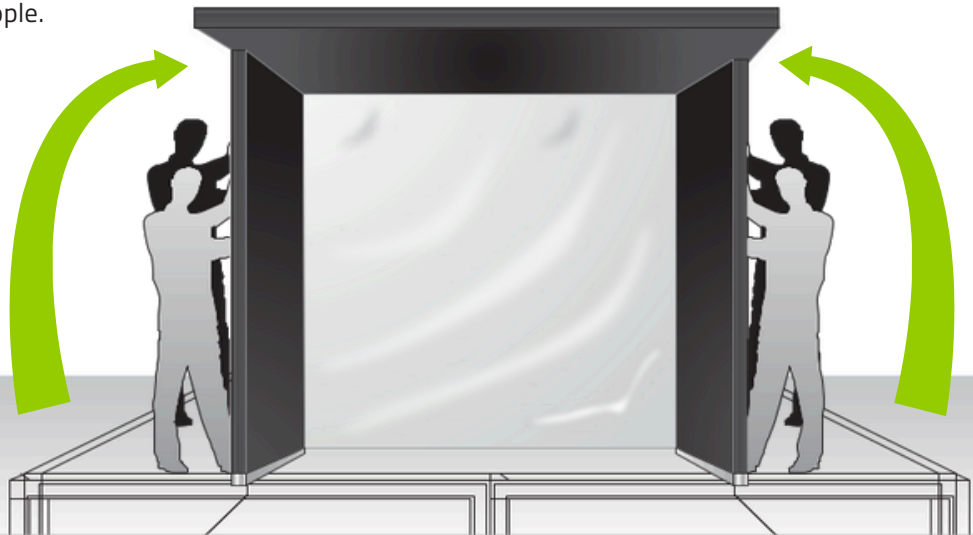

END OF STRUCTURE INSTALLATION SECTION

1

Install the floor sections in order (1 to 6). A and B you will need bolts washers and nuts. C you will need washers and nuts.

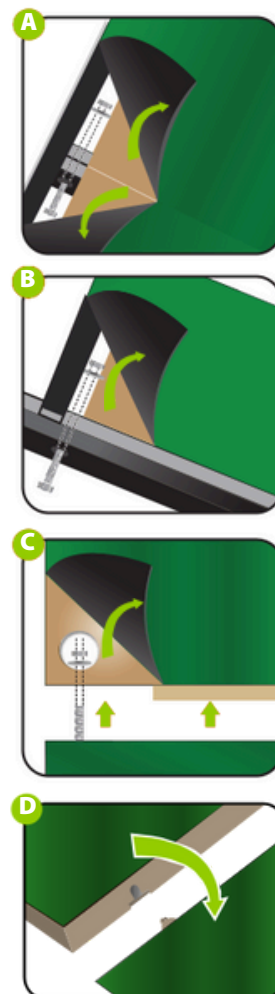
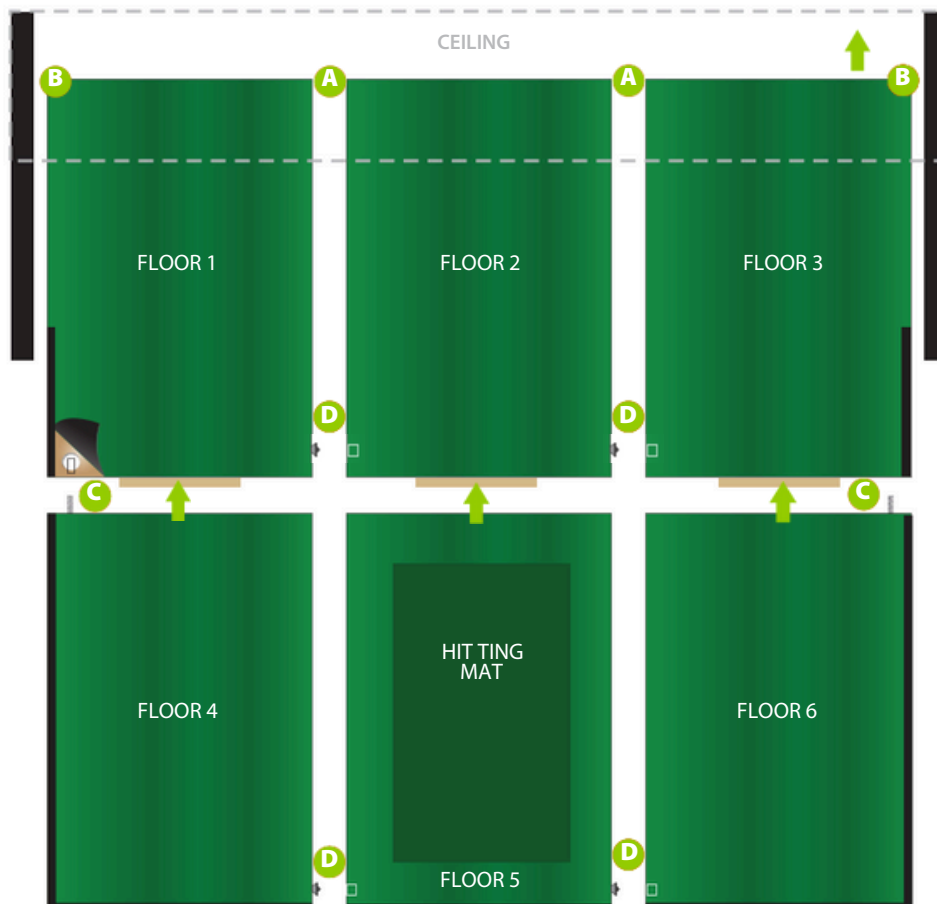

2

Step 1

Lift green carpet.

Step 2

Stretch the white screen behind and under the aluminum bar and reach for it through the space.

Step 3

Fix the screen on half of the velcro on the aluminum bar.

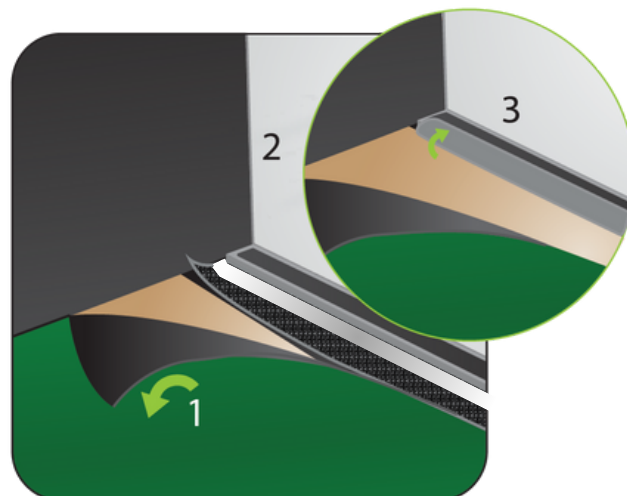

3

Step 1

Lift green carpet.

Step 2

Stretch the white screen behind and under the aluminum bar and reach for it through the space.

Step 3

Stick it on the first half of the aluminum bar velcro. Stick the T on the remaining half of the aluminum bar.

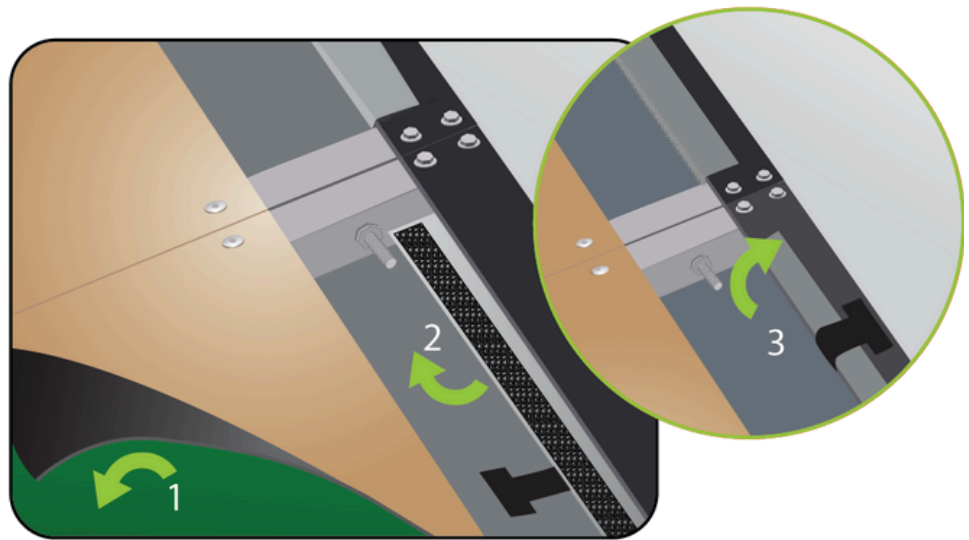

END OF STRUCTURE FLOOR INSTALLATION SECTION

HALF WALLS INSTALLATION

Simply cut through the front carpet of the bottom walls at 4 inches and 38 inches from the floor to access the pre-drill holes and insert the half-walls. Fix the half-walls to the structure with washers and nuts. Then, install the removable panel on the bottom walls with the velcro.



1

IDRA II INSTALLATION

Climb on a ladder and fix the IDRA II camera through the holes that are located at the center the structure. Then, secure it tightly with two nuts on the other side.

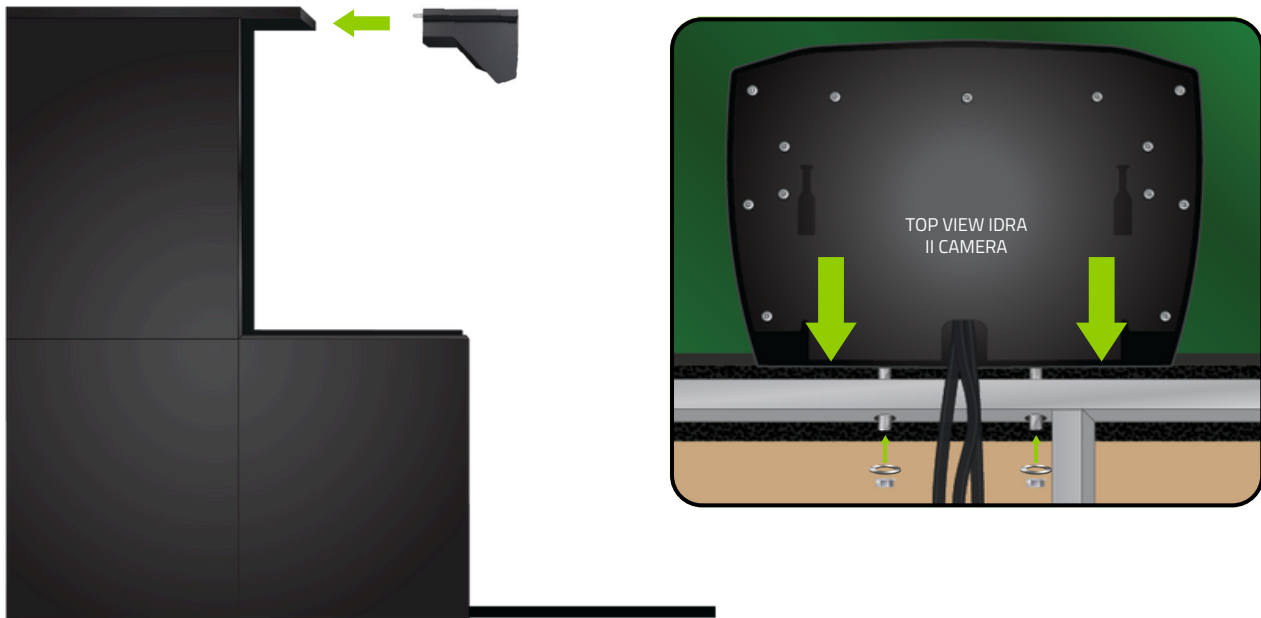

2

PROJECTOR BEAM INSTALLATION

Attach the projector beam to the ceiling structure with washers and nuts.

*If installed on the ceiling, refer to Appendix A for the right position.

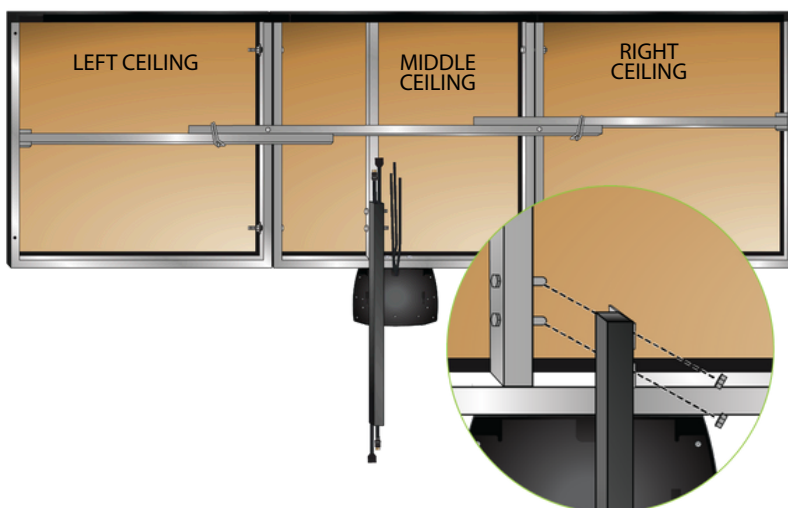

3

PROJECTOR INSTALLATION

Attach the projector on the projector mount. Refer to the instruction sheet inside the projector box.

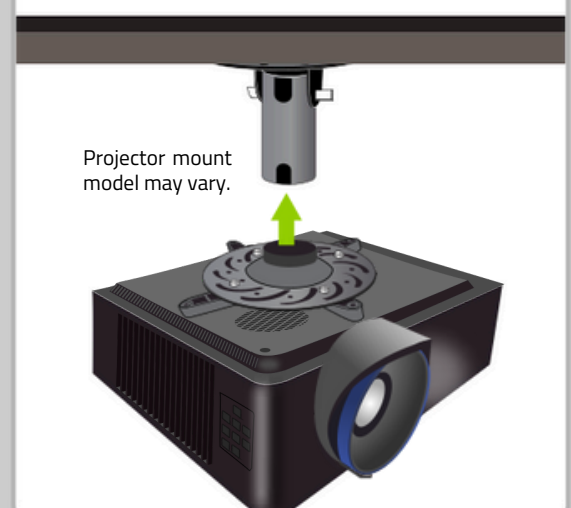

IDRA CABLE CONNECTIONS

Connect the power cable (country-specific) to the wireless remote switch. Then, plug the wireless remote switch into your electrical outlet. Connect one of the two USB camera cables to the USB 3.0 SS port on your PC and the other to the hub. Plug the hub into the USB-C port on your PC. Make sure the USB cables are not under tension.



PROJECTOR CABLE CONNECTIONS

Plug the HDMI cable to the HDMI port on your projector and on your PC. Connect the power cable to the ground terminal and your electrical outlet. Refer to Appendix B for your projector adjustments.

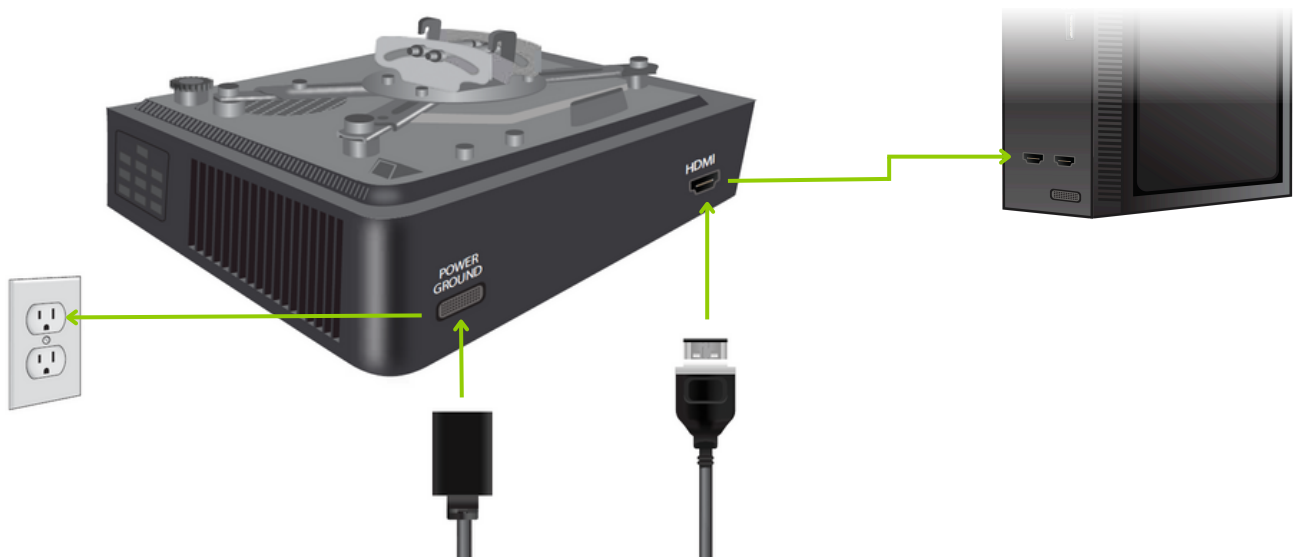

WIRE COVER

Stick one side of the wire cover to the structure using the Velcro. Gather your wires inside the wire cover and, forming a loop over the wires, stick the second side of the wire cover just in front of your first Velcro.

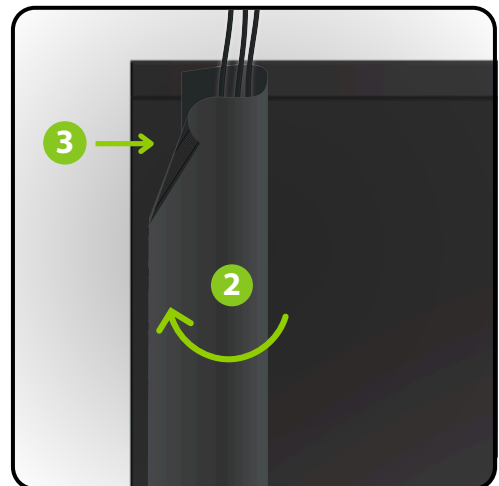
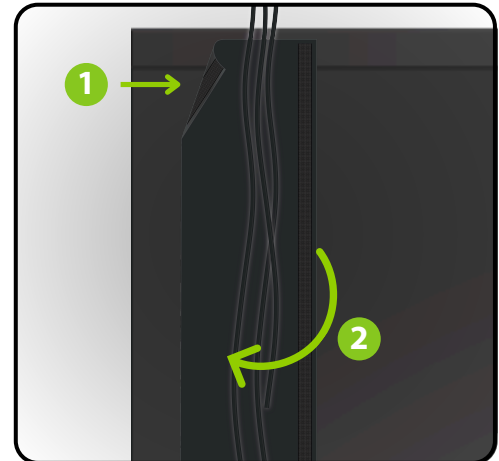

GOLFIN LAUNCHER INSTALLATION AND IDRA II CALIBRATION

Follow these steps to complete your installation:

STEP 1

Ensure your computer is connected to the Internet.

STEP 2

Confirm that you have purchased the necessary software. IDRA II is compatible with GSPro and E6 Connect.

STEP 3

Visit www.teamviewer.com, download, and install the latest version of TeamViewer Host.

STEP 4

Schedule an appointment with our support team on the day of installation to finalize the setup and configuration of your IDRA II camera.

**CLICK HERE TO
BOOK AN
APPOINTMENT**



<https://outlook.office365.com/owa/calendar/RSPTechnicalAssistance@golfin.com/bookings/>

PROJECTOR POSITION ON THE CEILING

Minimum projector distance:

150" (screen to lens)

- At this distance, the projector must be installed at a height of 88" (from the room floor to the center of the lens)

Maximum projector distance:

163" (screen to lens)

- At this distance, the projector must be installed at a height of 87 ½" (from the room floor to the center of the lens)

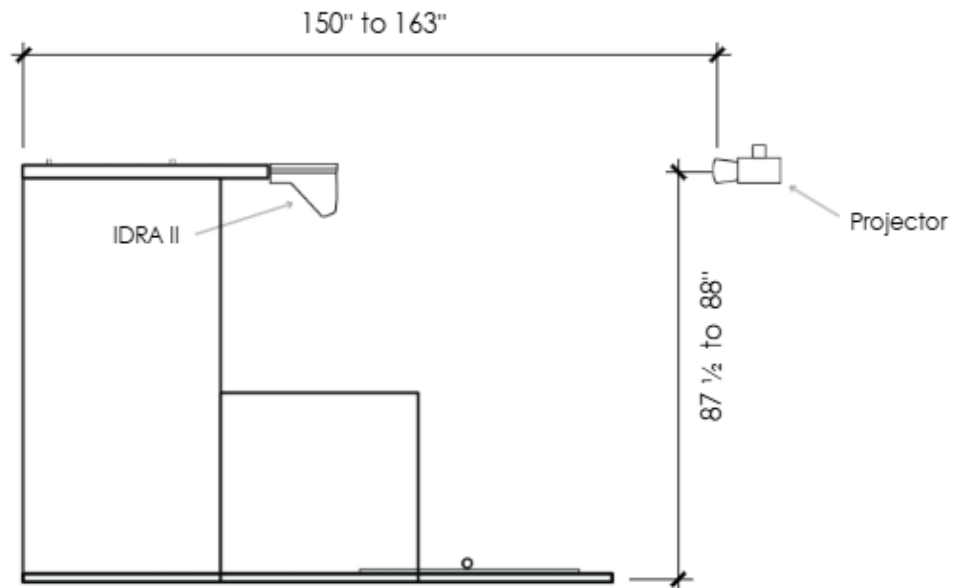

BENQ AK700ST PROJECTOR AJUSTEMENTS **WITH MONITOR**

TABLE OF CONTENTS

- | | |
|-----------------------------------|--------------------------|
| 1. Select the correct HDMI Source | 4. Projector Settings |
| 2. NVIDIA Control Panel (PC) | 5. Projector Ajustements |
| 3. Windows Display Settings (PC) | |

1.SELECT THE CORRECT HDMI SOURCE

- 1.Turn on the projector and press the 'Source' button on the remote control.
- 2.Use the arrows to navigate to the appropriate HDMI input (HDMI 1 or HDMI 2) and press 'OK' to select.

2.WINDOWS DISPLAY SETTINGS (PC)

1. Open the NVIDIA Control Panel & make sure the projector is turned on.
2. Click on "Adjust desktop size and position"
3. Select your monitor
4. Select "Aspect ratio"
5. Keep the resolution at 1920 × 1080
6. Select your projector
7. Select "Aspect ratio"
8. Keep the resolution at 1920 × 1080
9. Click "Apply" at the bottom right of the screen. Then "Yes" to "Apply Changes"

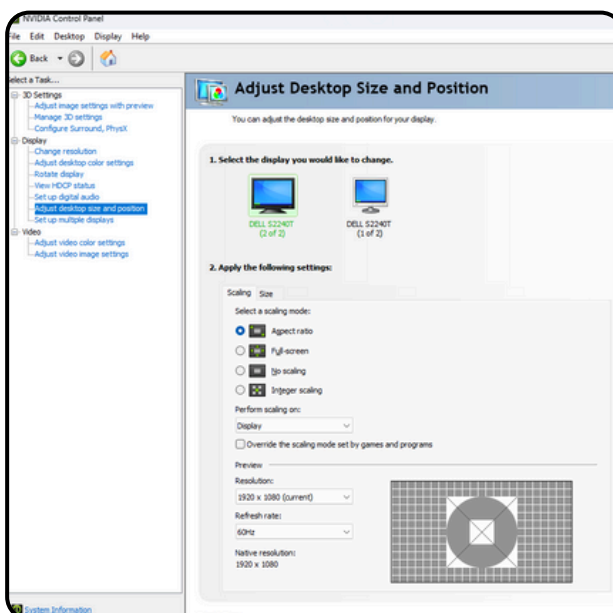

3. WINDOWS DISPLAY SETTINGS (PC)

1. Click Start > Settings
2. Go to System > Display
3. If both screens are detected, you will see two numbered rectangles (1 and 2)
4. Click on Extend these Display (menu below and to the right of the 2 screens)
5. Select "Duplicate these displays"
6. Click "Keep Change"
7. Make sure the display resolution is set to 1920 x 1080

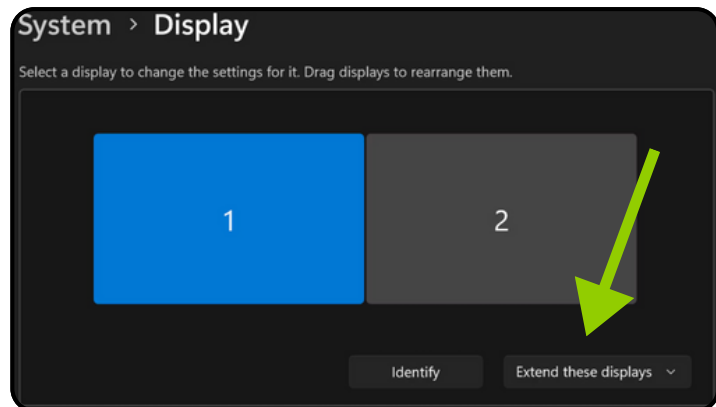

4. PROJECTOR SETTINGS

1. Turn on your Projector
2. Auto Screen Fit / Ok
3. Menu / Select Projector Position
4. Language: Select the desired language
5. Press Menu (On the remote) : Menu Type / Choose Advanced
6. Picture / Picture Mode: Select Golf

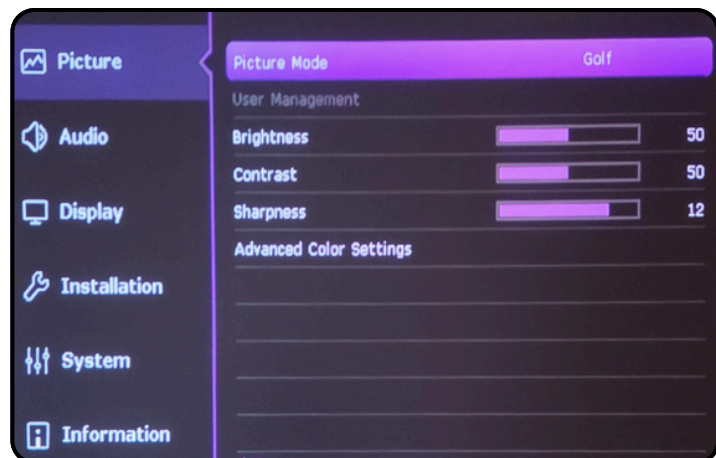

7. Display / Aspect Ratio / 16:9

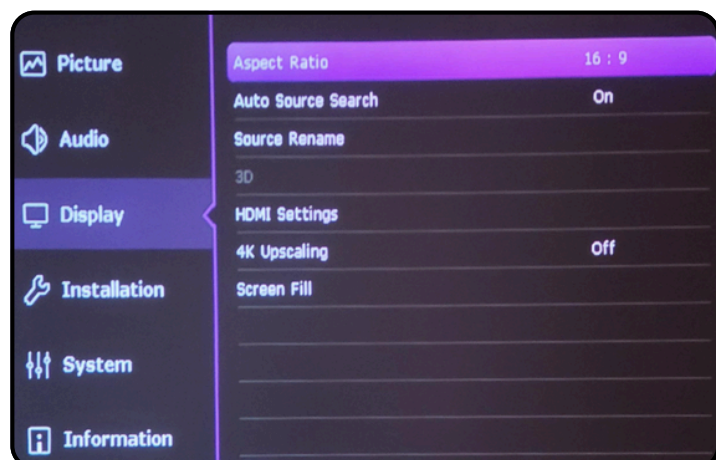

5. PROJECTOR AJUSTEMENTS

Each environment is unique, so this section may require a bit more time and patience. Depending on your setup (screen size, projector distance, ceiling height, etc.), the adjustments needed can vary significantly from one user to another.

Take the time to explore and combine the different adjustments below to achieve an image perfectly suited to your installation. Don't hesitate to repeat the process multiple times to fine-tune the result to your preferences.

- Installation / Image Resize / Digital Shrink & Shift



- Installation / Geometry / Corner Fit :
Fine-tune the image size and position for precise alignment



5. PROJECTOR AJUSTEMENTS (CONTINUED)

- Installation / Focus / Focus / Ok



- After the auto-focus, fine-tune the focus using the left and right arrows on the remote.

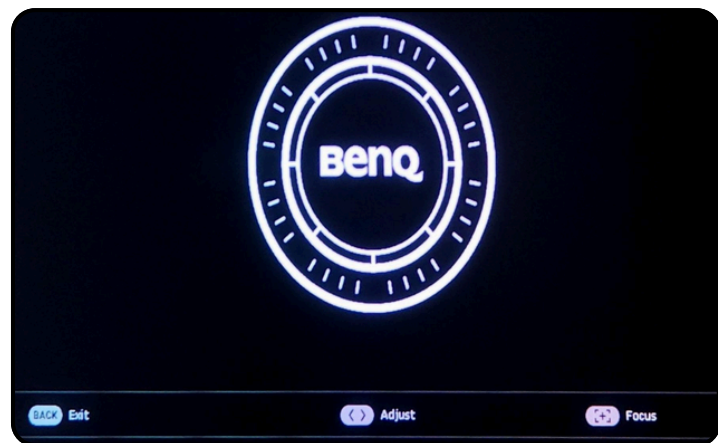

BENQ AK700ST PROJECTOR AJUSTEMENTS WITHOUT MONITOR

TABLE OF CONTENTS

1. Select the correct HDMI Source
2. NVIDIA Control Panel (PC)
3. Windows Display Settings (PC)
4. Projector Settings
5. Projector Ajustements

1.SELECT THE CORRECT HDMI SOURCE

- 1.Turn on the projector and press the 'Source' button on the remote control.
- 2.Use the arrows to navigate to the appropriate HDMI input (HDMI 1 or HDMI 2) and press 'OK' to select.

2.WINDOWS DISPLAY SETTINGS (PC)

1. Open the NVIDIA Control Panel
2. Click on Change resolution:
Customise > Create custom resolution
3. Under Display mode (as reported by Windows), Change :
 - Horizontal pixels to 1547
 - Vertical Lines to 1080
4. Click on Test > Apply change > Yes
5. Click on Adjust desktop size and position:
6. Select "Full screen" (The projector must be turned on beforehand)
7. Change the Resolution to 1547 × 1080
8. Click "Apply" at the bottom right of the screen. Then "Yes" to "Apply Changes"

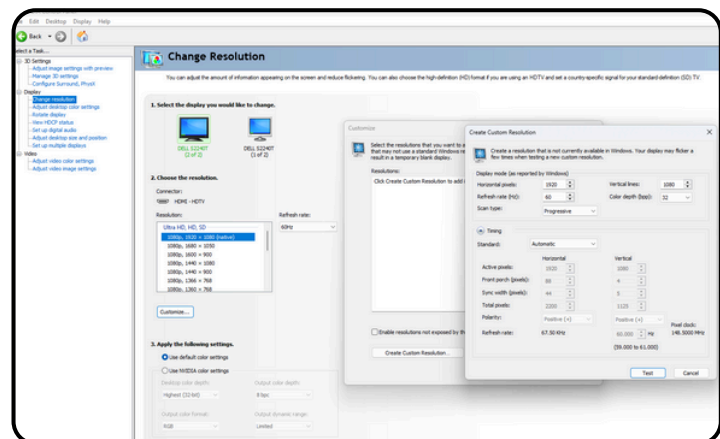

3. WINDOWS DISPLAY SETTINGS (PC)

1. Click Start > Settings
2. Go to System > Display
3. Make sure the display resolution is set to 1547 × 1080
4. If not, change it & Click "Yes" to keep these display setting

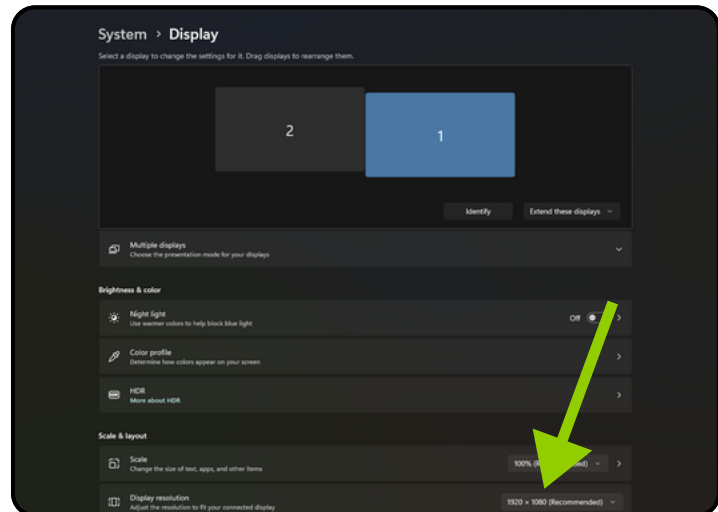

4. PROJECTOR SETTINGS

1. Turn on your Projector
2. Auto Screen Fit / Ok
3. Menu / Select Projector Position
4. Language: Select the desired language
5. Press Menu (On the remote) : Menu Type / Choose Advanced
6. Picture / Picture Mode: Select Golf

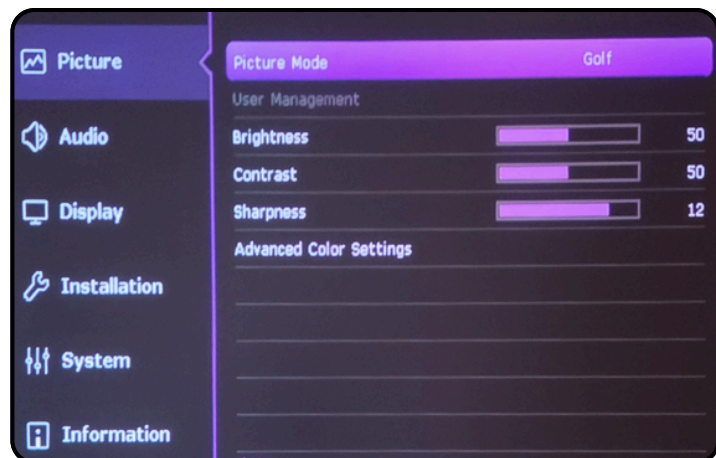

7. Display / Aspect Ratio / 16:9

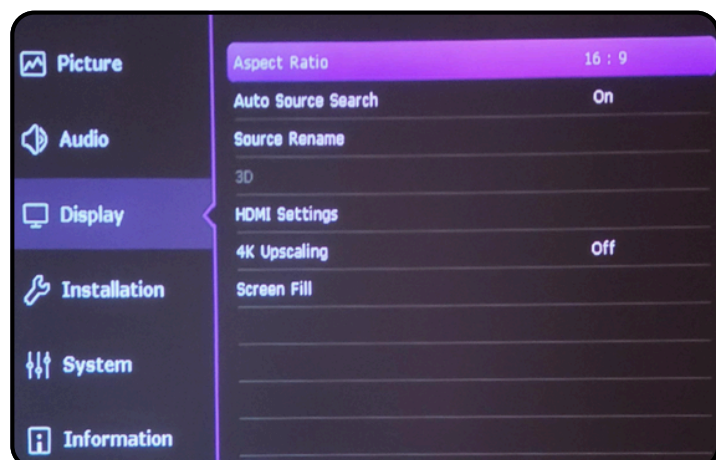

5. PROJECTOR AJUSTEMENTS

Each environment is unique, so this section may require a bit more time and patience. Depending on your setup (screen size, projector distance, ceiling height, etc.), the adjustments needed can vary significantly from one user to another.

Take the time to explore and combine the different adjustments below to achieve an image perfectly suited to your installation. Don't hesitate to repeat the process multiple times to fine-tune the result to your preferences.

- Installation / Image Resize / Digital Shrink & Shift



- Installation / Geometry / Corner Fit :
Fine-tune the image size and position for precise alignment



5. PROJECTOR AJUSTEMENTS (CONTINUED)

- Installation / Focus / Focus / Ok



- After the auto-focus, fine-tune the focus using the left and right arrows on the remote.

