

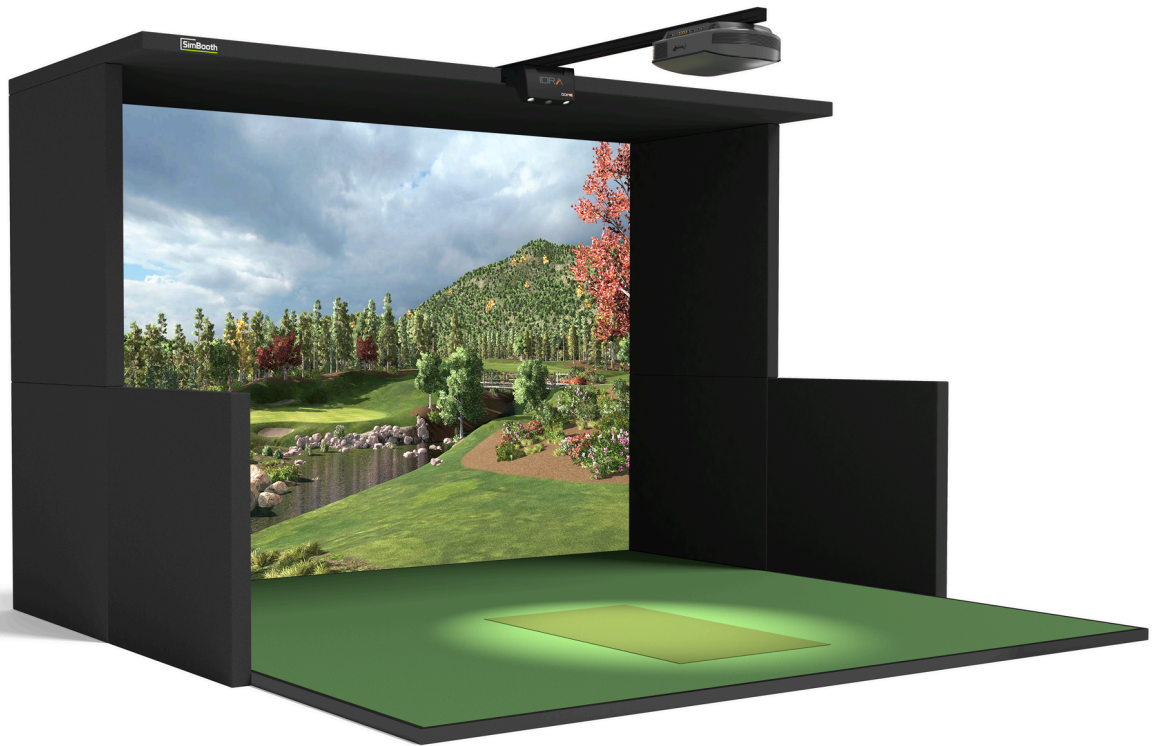

INSTALLATION GUIDE  
SIMBOOTH KIT 2

# TABLE OF CONTENTS

Important information .....	1
PC specifications .....	2
Parts list .....	3-4
Structure installation .....	5-9
Floor installation .....	10-11
Half walls installation .....	11
Electronics installation .....	12
Cable connections .....	13-14
IDRA II installation .....	15
Appendix A .....	16
Appendix B .....	17-20



**WARNING**

**PLEASE READ THE FOLLOWING BEFORE USE.**

**FAILURE TO FOLLOW THE INSTRUCTIONS COULD RESULT IN SERIOUS INJURY, PROPERTY DAMAGE, AND/OR VOID THE DEVICE WARRANTY.**

- 1.** Do NOT install IDRA II in a location where its operating temperature may be exceeded. Excessive temperatures may damage the launch monitor. Recommended operating temperature range is 0°C – 50°C (32°F – 122°F).
- 2.** Install IDRA II in a room free of excessive dust and humidity to prevent the lens or optical components of IDRA II from becoming clouded or dirty.
- 3.** Do NOT attempt to disassemble, repair, or modify IDRA II. Doing so may result in fire, electrical shock, or injury. Contact our support team if any problems occur with the launch monitor.
- 4.** Make sure the hitting zone is not located in direct sun exposure.
- 5.** Be aware of your surroundings and use cautiously with children around.
- 6.** Do NOT install IDRA II outside. This device is only designed for indoor use.
- 7.** Do NOT touch the LED light as it may cause burns, and avoid looking directly at the light to prevent potential eye damage.

### PC SPECIFICATIONS WITH GSPRO

Requirement	Minimum	Recommended
Processor	Intel i7 10th Gen + 16 logical processors	<b>Intel i7 10th Gen + 24 logical processors</b>
Storage	512 GB	<b>1 TB</b>
GPU	Nvidia GeForce RTX 20 series	<b>Nvidia GeForce RTX 40 series</b>
RAM memory	16 GB	<b>32 GB</b>
USB Ports	2 USB 3.0 ports are required	
Internet	High-speed Internet is required	

### PC SPECIFICATIONS WITH E6 CONNECT

Requirement	Minimum	Recommended
Processor	Intel i7 10th Gen + 16 logical processors	
Storage	512 GB	
GPU	Nvidia GeForce RTX 20 series	<b>Nvidia GeForce RTX 30 series</b>
RAM memory	16 GB	
USB Ports	2 USB 3.0 ports are required	
Internet	High-speed Internet is required	



**WARNING**

**AMD PROCESSORS ARE NOT SUPPORTED.**

**DO NOT USE USB CABLE EXTENSION BETWEEN YOUR PC AND YOUR IDRA II.**

# PARTS LIST

## WALL PANELS

### RIGHT WALLS



### LEFT WALLS



## FLOOR PANELS

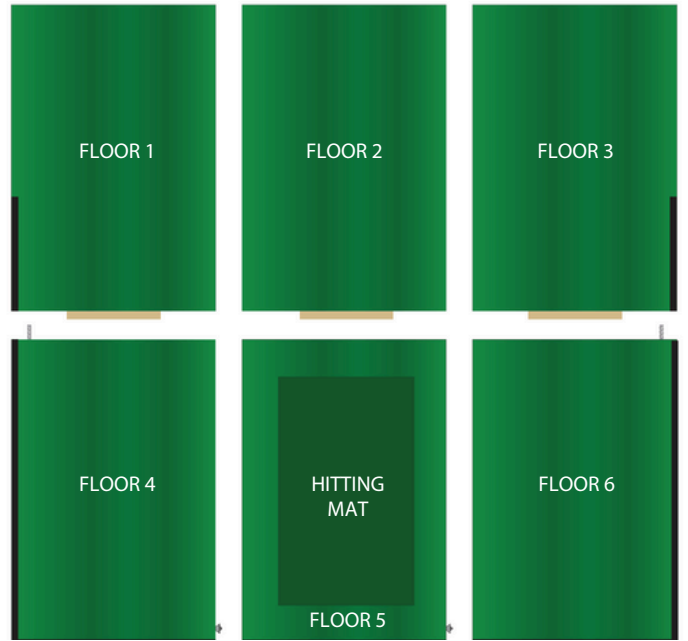

## CEILING PANELS

### BACK CEILINGS



### FRONT CEILINGS



# PARTS LIST

## ACCESSORIES

Bolts

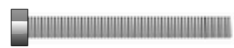

3-1/2" (10x)

Washer (42x)



Nuts (32x)



Hitting mat



Black impact screen



Ceiling truss



Projector and remote



White screen



Tees (10x)



Half wall (2x)

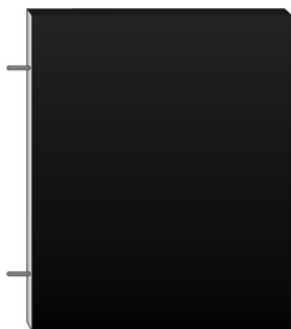

Projector beam



Wire Cover



## LAUNCH MONITOR

IDRA II AI launch monitor



With power cable and two  
USB camera cables (1x)

Calibration board (1x)



Wireless remotely  
operated switch (1x)  
(Only included in North America)



For illustration purposes only. Model may vary.

Nuts (2x)



END OF PARTS LIST

**BEFORE STARTING**

You will need 4 people, 2 ladders, a screwdriver and 1/2 wrench.



**1**

Fix the left top wall to the left front ceiling with the nuts.



**2**

Using the nuts, fix the center front ceiling to the left front ceiling, then fix the right front ceiling to the center front ceiling.



**3**

Using the nuts, fix the right front ceiling to the right top wall.

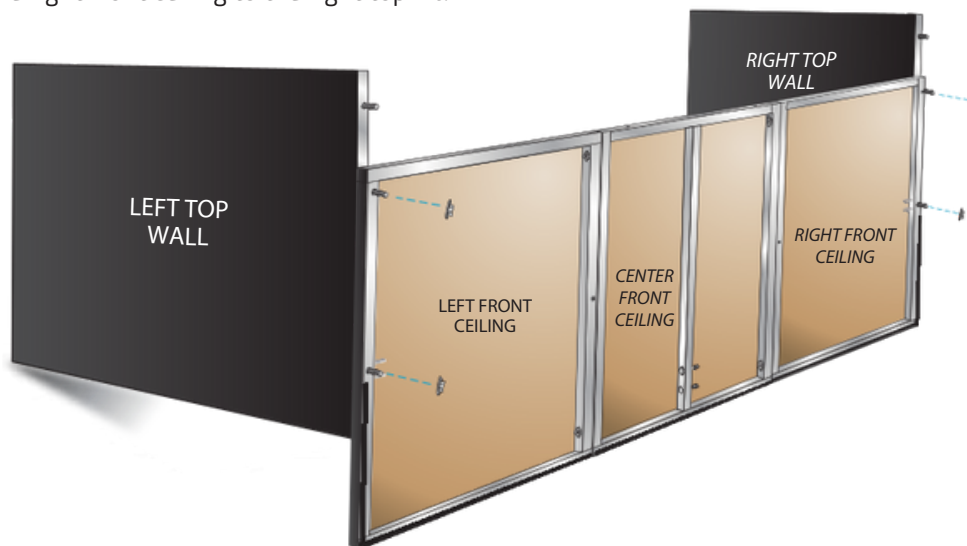
**4**

Fix both bottom wall panels to the top wall panels with the nuts by removing the bottom wall covers (velcro).

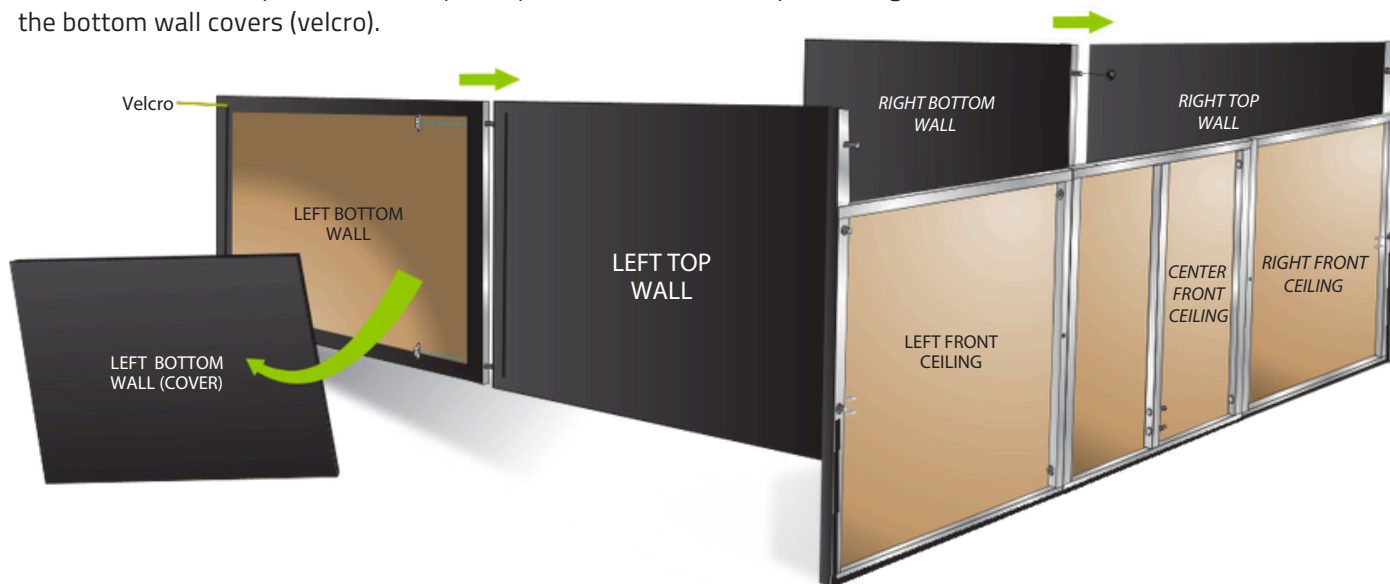



5

Fix the left back ceiling to the left top wall with the nuts.



6

Using the nuts, fix the center back ceiling to the left back ceiling and fix the two center ceilings together.

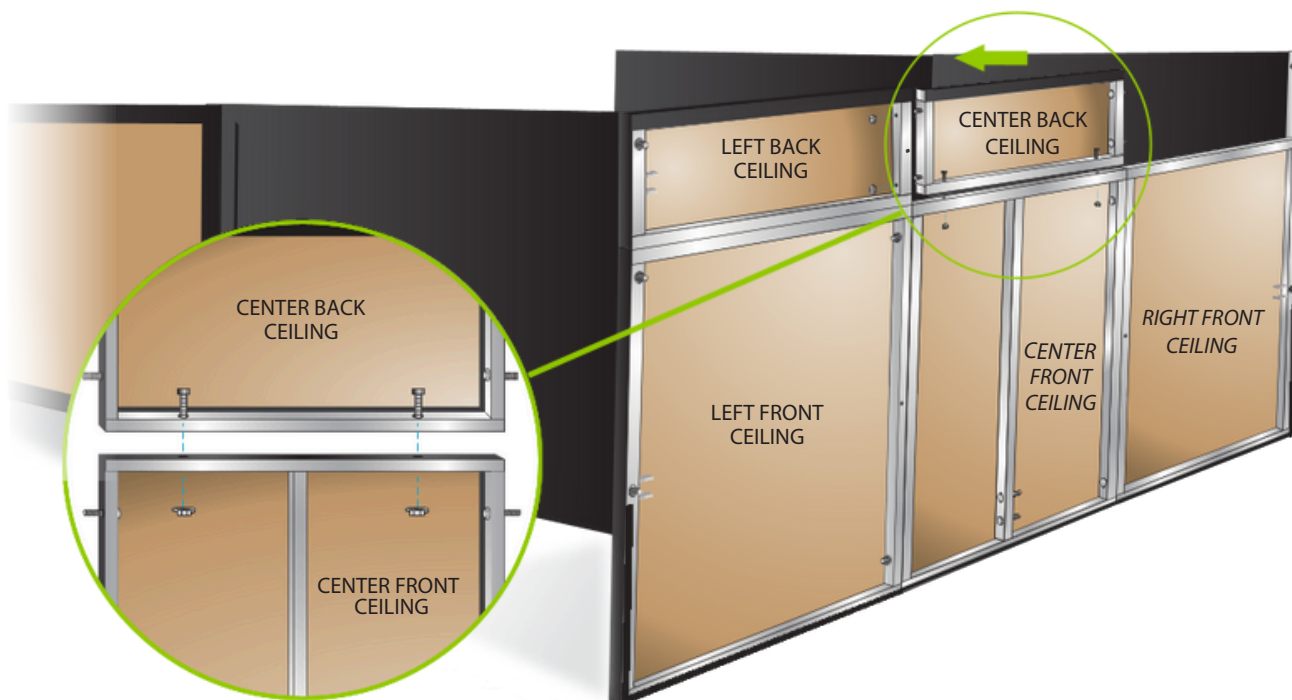

7

Fix the right back ceiling to the center back ceiling and to the right top wall with the nuts.



8

**CEILING TRUSS INSTALLATION**

Assemble the ceiling trusses with bolts and security pins, then insert them in the back ceiling and the front ceiling.

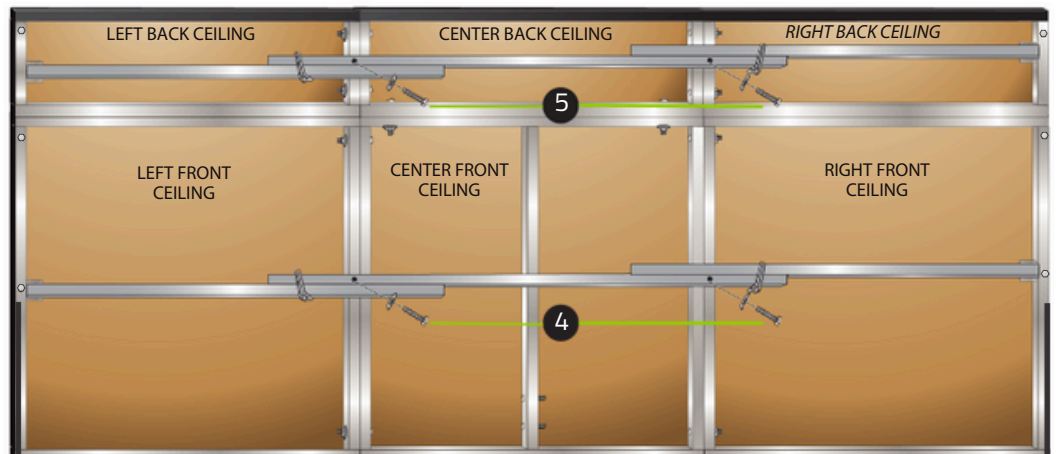
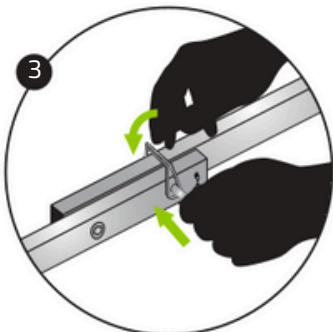
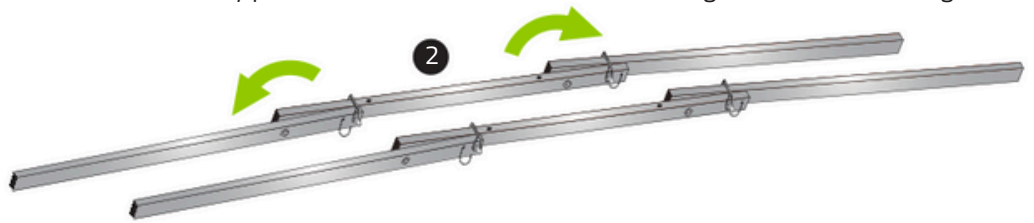
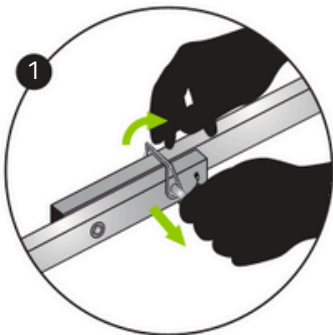

**IT IS IMPORTANT TO COMPLETE THIS STEP BEFORE LIFTING THE STRUCTURE.**

**9**

Attach the white screen to the structure.

**10**

Attach the black netting over the white screen. Make sure it is attached to the top velcro on the ceiling panels and that the bottom doesn't rest on the floor.

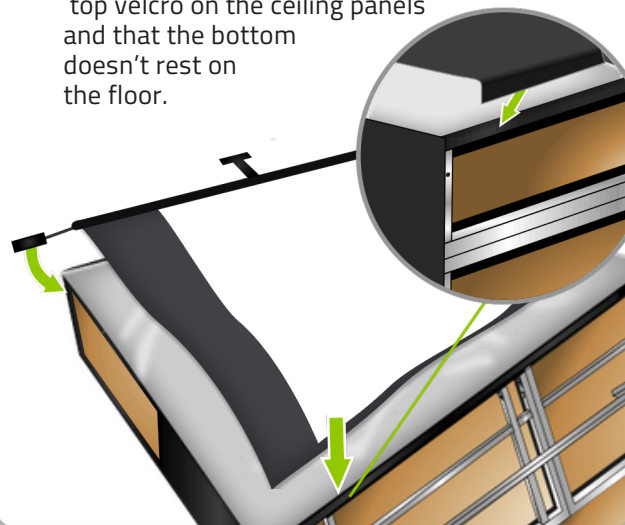
**11**

Lift the structure with four people.



END OF STRUCTURE INSTALLATION SECTION

1

Install the floor sections in order (1 to 6). A and B you will need bolts washers and nuts. C you will need washers and nuts.

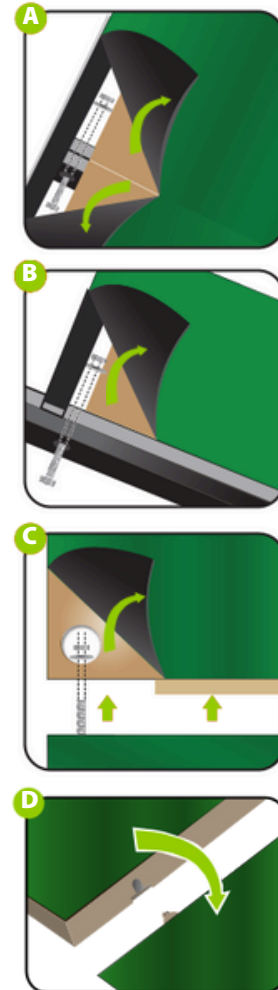
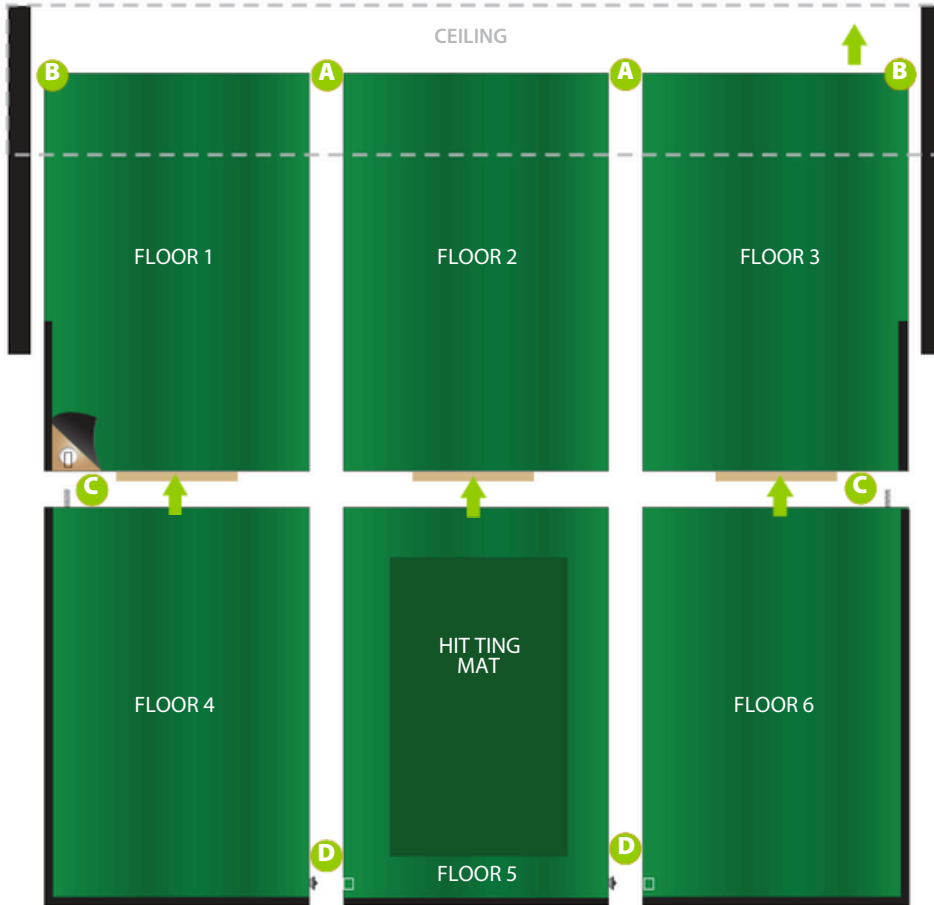

2

**Step 1**

Lift green carpet.

**Step 2**

Stretch the white screen behind and under the aluminum bar and reach for it through the space.

**Step 3**

Fix the screen on half of the velcro on the aluminum bar.

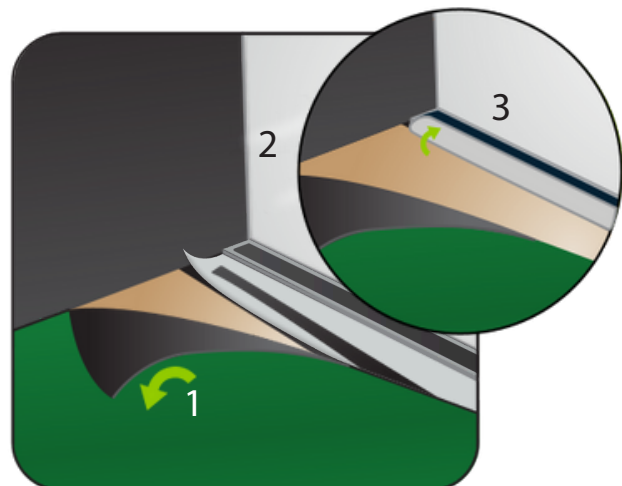

3

**Step 1**

Lift green carpet.

**Step 2**

Stretch the white screen behind and under the aluminum bar and reach for it through the space.

**Step 3**

Stick it on the remaining half of the aluminum bar velcro.

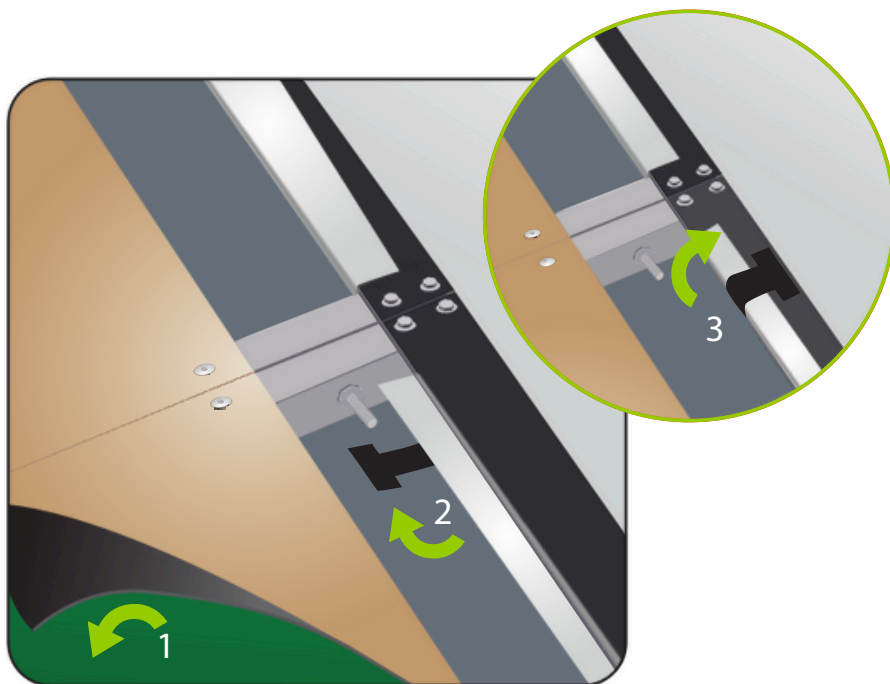

END OF STRUCTURE FLOOR INSTALLATION SECTION

**HALF WALLS INSTALLATION**

Fix the half-walls to the structure with washers and nuts. Then, install the removable panel on the bottom walls with the velcro.



1

### IDRA II INSTALLATION

Climb on a ladder and fix the IDRA II camera through the holes that are located at the center the structure. Then, secure it tightly with two nuts on the other side.

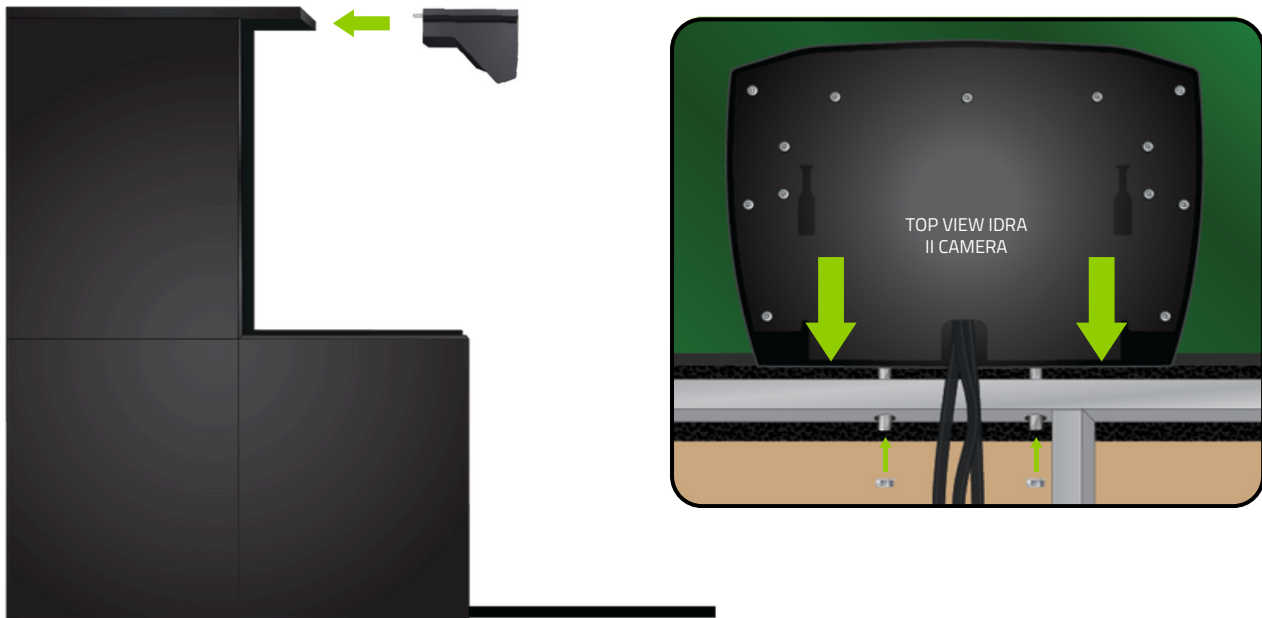

2

### PROJECTOR BEAM INSTALLATION

Attach the projector beam to the ceiling structure with washers and nuts.

\*If installed on the ceiling, refer to Appendix A for the right position.

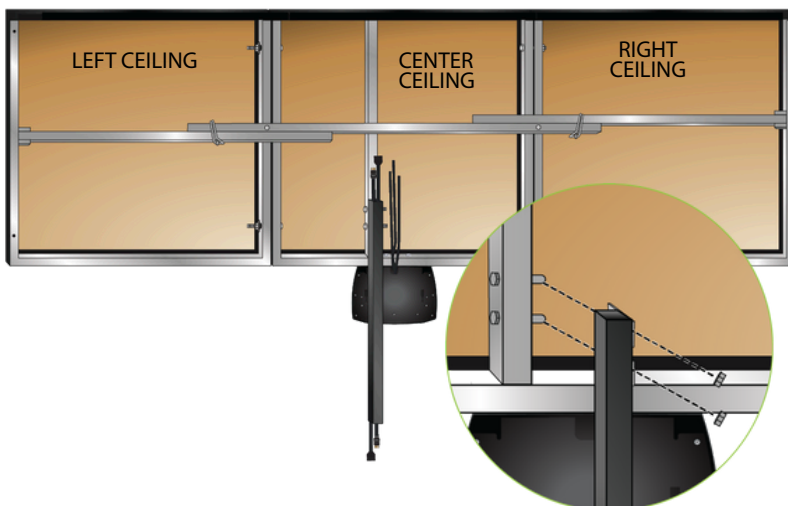

3

### PROJECTOR INSTALLATION

Attach the projector on the projector mount. Refer to the instruction sheet inside the projector box.

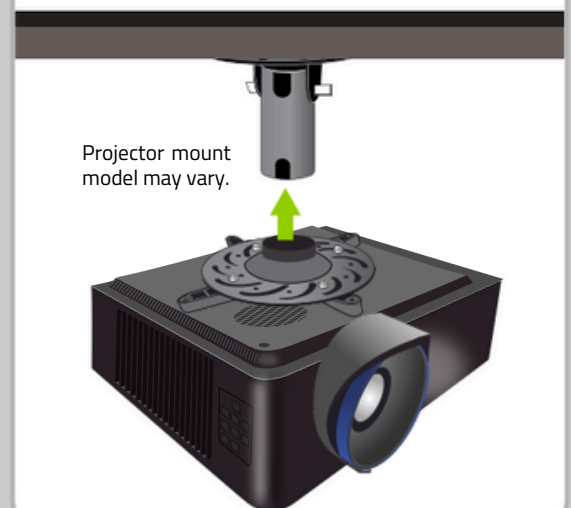

### IDRA CABLE CONNECTIONS

Connect the power cable (country-specific) to the wireless remotely operated switch. Connect your wireless remotely operated switch to your electrical outlet. Plug the two USB camera cables to your 3.0 USB SS port on your PC. Ensure that there is no tension on the USB cables.



### PROJECTOR CABLE CONNECTIONS

Plug the HDMI cable to the HDMI port on your projector and on your PC. Connect the power cable to the ground terminal and your electrical outlet. Refer to Appendix B for your projector adjustments.

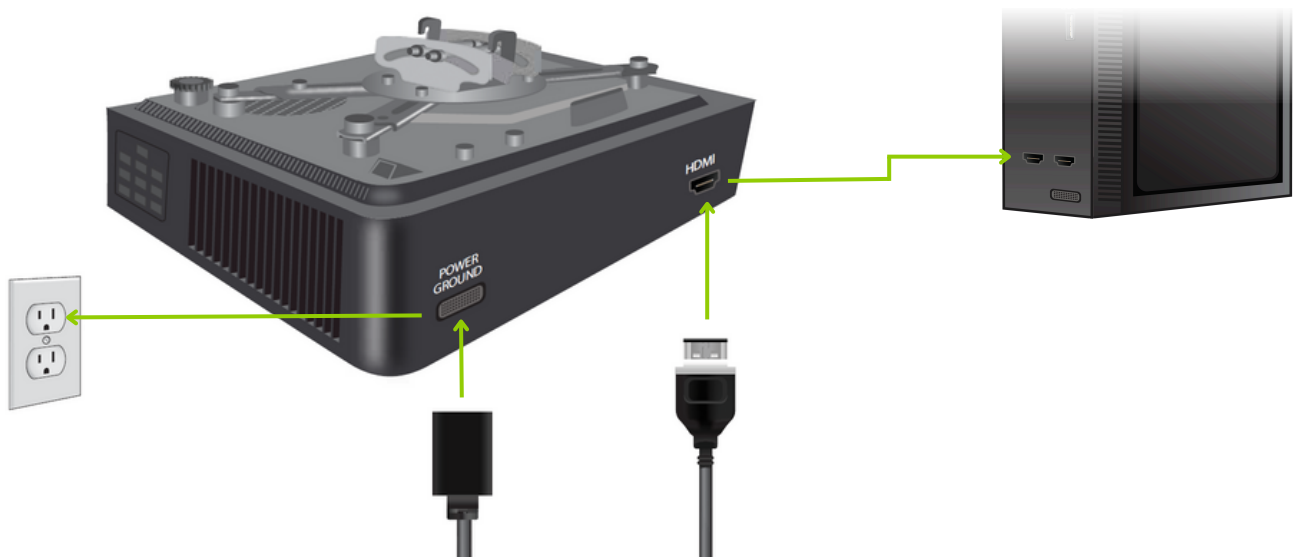

## WIRE COVER

Stick one side of the wire cover to the structure using the Velcro. Gather your wires inside the wire cover and, forming a loop over the wires, stick the second side of the wire cover just in front of your first Velcro.

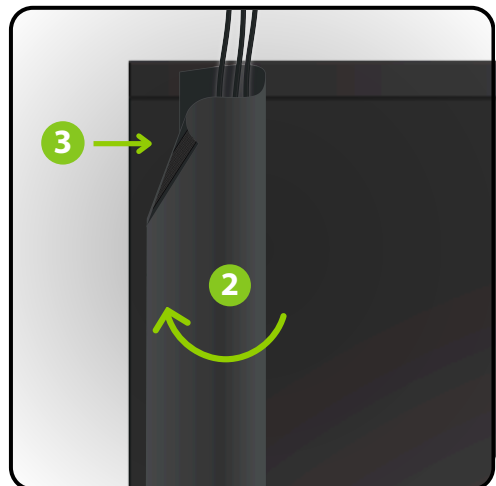
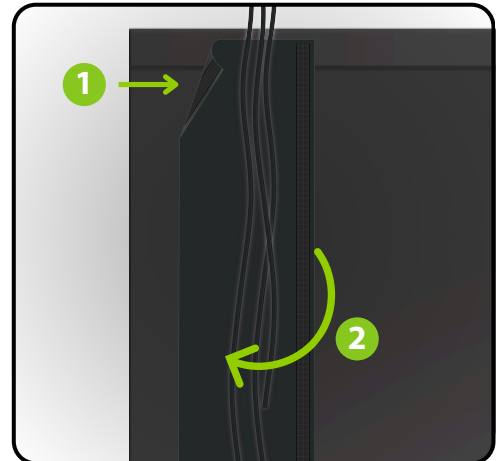



## GOLFIN LAUNCHER INSTALLATION AND IDRA II CALIBRATION

Follow these steps to complete your installation:

### STEP 1

Ensure your computer is connected to the Internet.

### STEP 2

Confirm that you have purchased the necessary software. IDRA II is compatible with GSPPro and E6 Connect.

### STEP 3

Visit [www.teamviewer.com](http://www.teamviewer.com), download, and install the latest version of TeamViewer Host.

### STEP 4

Schedule an appointment with our support team on the day of installation to finalize the setup and configuration of your IDRA II camera.

**CLICK HERE TO  
BOOK AN  
APPOINTMENT**



<https://outlook.office365.com/owa/calendar/RSPTechnicalAssistance@golfinsim.com/bookings/>

### PROJECTOR POSITION WITHOUT PROJECTOR BEAM

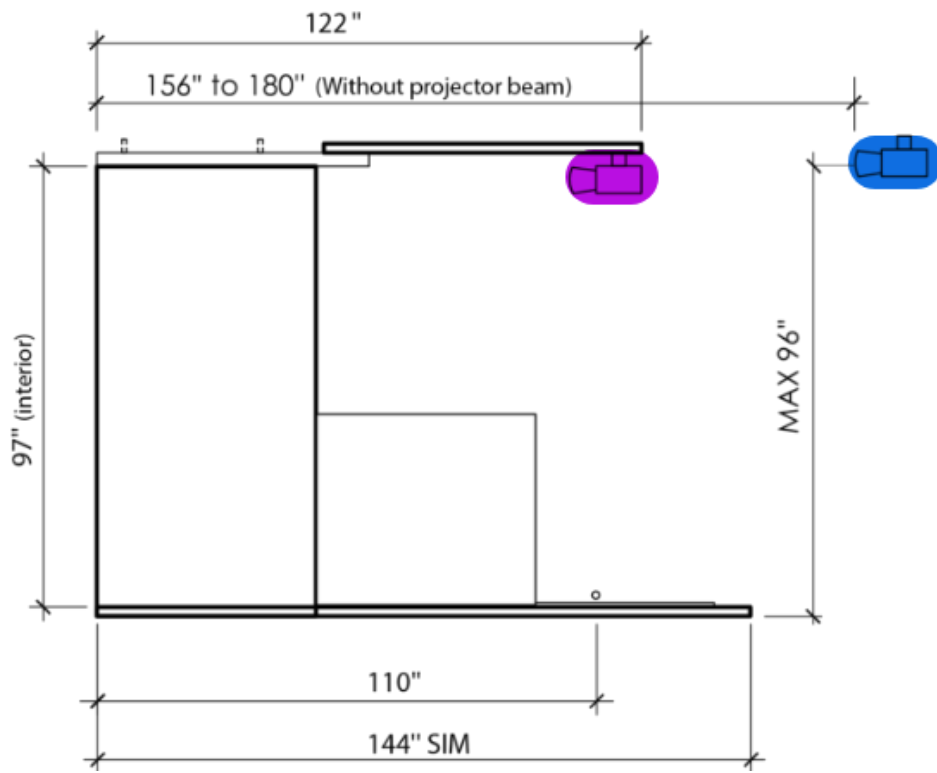

# BENQ LH600ST PROJECTOR AJUSTEMENTS

## TABLE OF CONTENTS

- |  |  |
|--|--|
| 1. Select the correct HDMI Source                    | 5. Display / Aspect Ratio / 16:10                    |
| 2. System / Language                                 | 6. Display / Image Resize / Digital Shrink and Shift |
| 3. Settings / Projector Installation / Front Ceiling | 7. Display / Corner fit                              |
| 4. Picture / Golf                                    | 8. Zoom and Focus                                    |

## 1. SELECT THE CORRECT HDMI SOURCE

### STEP 1

Turn on the projector and press the 'Source' button on the remote control.

### STEP 2

Use the arrows to navigate to the appropriate HDMI input (HDMI 1 or HDMI 2) and press 'OK' to select.

## 2. SYSTEM / LANGUAGE

### STEP 1

Press the 'Menu' button on the remote control.

### STEP 2

Go to 'System' then 'Language'.

### STEP 3

Select the desired language for the projector interface.

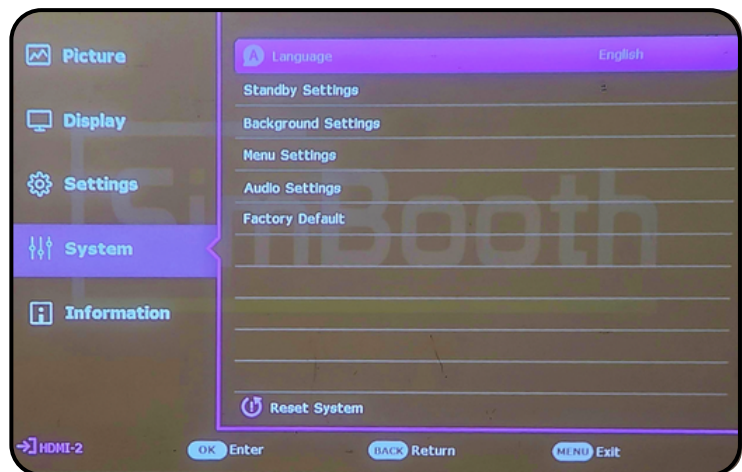

### 3. SETTINGS / PROJECTOR INSTALLATION / FRONT CEILING

**STEP 1**

Press the 'Menu' button on the remote control.

**STEP 2**

Go to 'Settings'.

**STEP 3**

Select 'Projector Installation' and set it to 'Front Ceiling'.

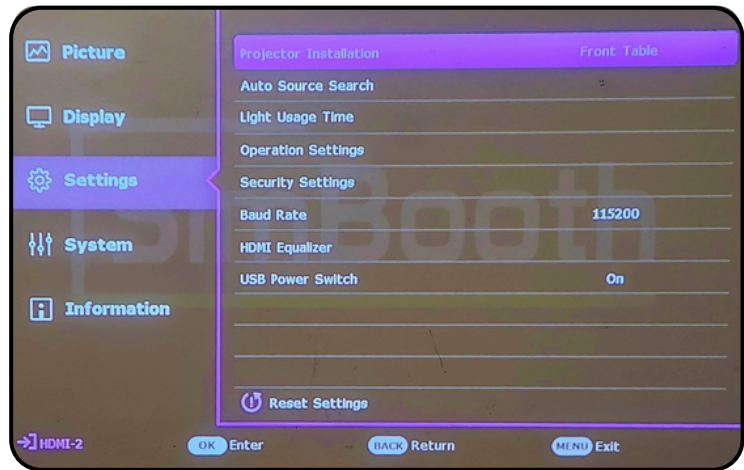

### 4. PICTURE / GOLF

**STEP 1**

Press the 'Menu' button on the remote control.

**STEP 2**

Go to 'Picture' then select the 'Golf' mode in 'Picture mode'

**This mode optimizes colors for golf simulators, making greens and blues more vivid.**

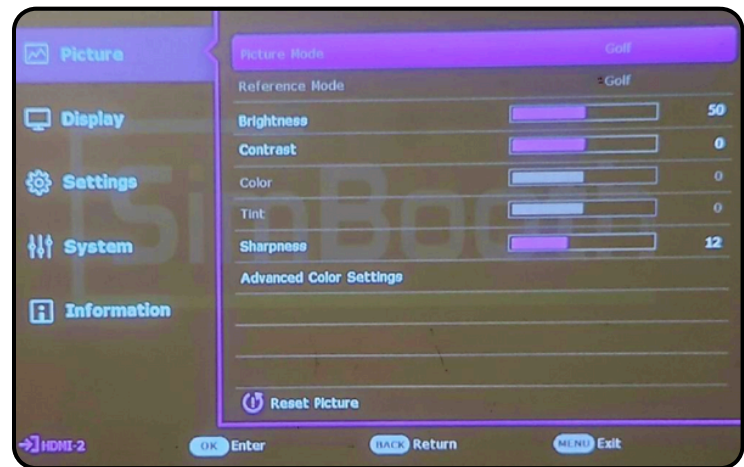

## 5. DISPLAY / ASPECT RATIO / 16:10

### STEP 1

Press the 'Menu' button on the remote control.

### STEP 2

Go to 'Display' then 'Aspect Ratio'.

### STEP 3

Select the '16:10' format to adjust the image to this ratio.

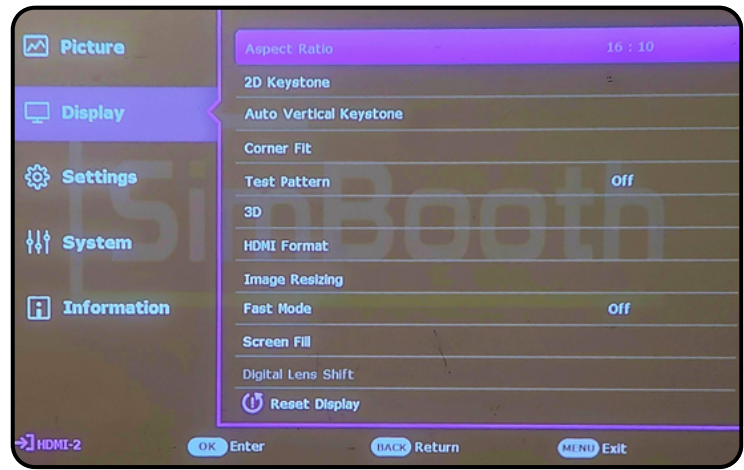

## 6. DISPLAY / IMAGE RESIZE / DIGITAL SHRINK AND SHIFT

### STEP 1

Press the 'Menu' button on the remote control.

### STEP 2

Go to 'Display' then 'Image Resize'.

### STEP 3

Select 'Digital Shrink and Shift' to adjust the size and position of the projected image.

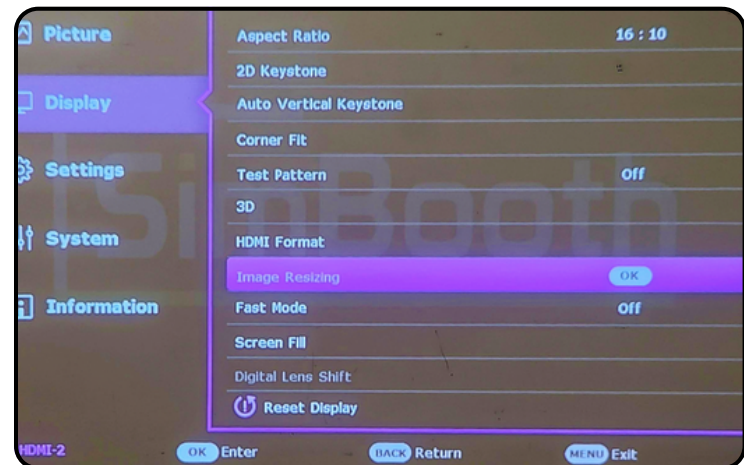

## 7. DISPLAY / CORNER FIT

### STEP 1

Press the 'Menu' button on the remote control.

### STEP 2

Go to 'Display' then 'Corner Fit'.

### STEP 3

Use the arrows to adjust each corner of the image to correct any distortion and achieve a perfectly aligned image.

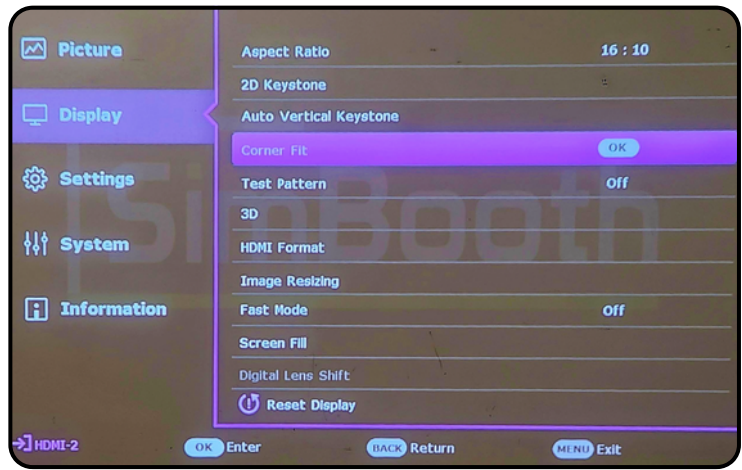

## 8. ZOOM AND FOCUS

### ZOOM

Turn the zoom ring on top of the lens to adjust the size of the projected image.



### FOCUS

Use the focus ring, also located on top of the lens, to adjust the sharpness of the image. Turn the ring until the image is clear and sharp.

