



# INSTALLATION GUIDE

SIMBOOTH 2

# TABLE OF CONTENTS

|                                |       |
|--------------------------------|-------|
| Parts list .....               | 3-4   |
| Structure installation .....   | 5-9   |
| Floor installation .....       | 10-11 |
| Half walls installation .....  | 11    |
| Electronics installation ..... | 12    |
| Cable connections .....        | 13    |
| Appendix A .....               | 14    |
| Appendix B .....               | 15-18 |

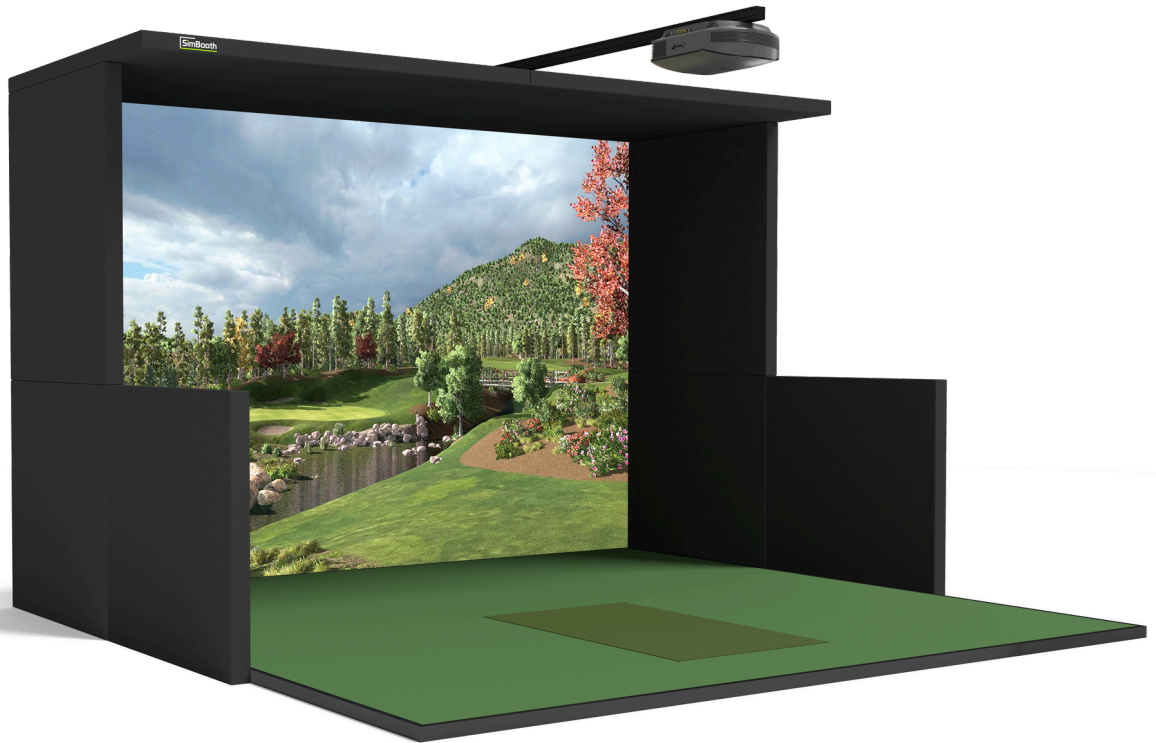

# PARTS LIST

## WALL PANELS

### RIGHT WALLS



### LEFT WALLS



## FLOOR PANELS

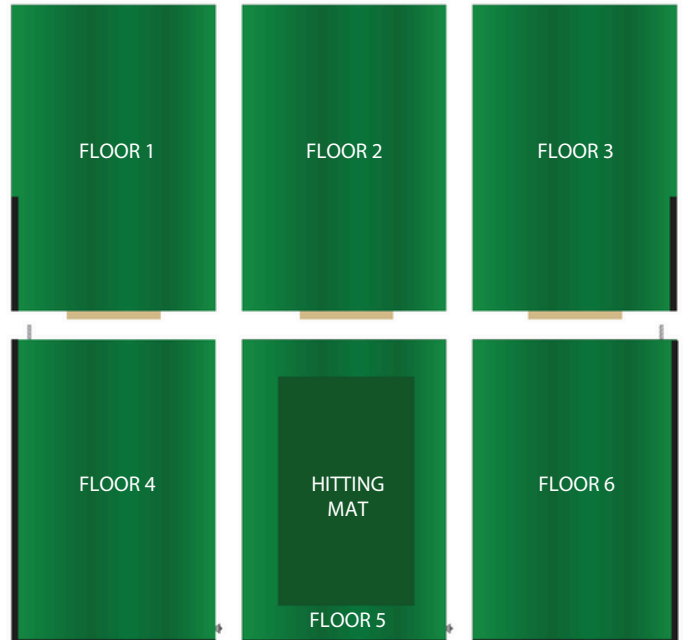

## CEILING PANELS

### BACK CEILINGS



### FRONT CEILINGS



# PARTS LIST

## ACCESSORIES

Bolts

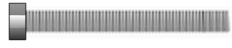

3-1/2" (10x)

Washer (42x)



Nuts (32x)



Hitting mat



Black impact screen



Ceiling truss



Projector and remote



White screen



Tees (10x)



Half wall (2x)

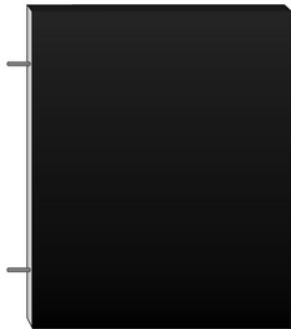

Projector beam



Wire Cover



END OF PARTS LIST

**BEFORE STARTING**

You will need 4 people, 2 ladders, a screwdriver and 1/2 wrench.



**1**

Fix the left top wall to the left front ceiling with the nuts.



**2**

Using the nuts, fix the center front ceiling to the left front ceiling, then fix the right front ceiling to the center front ceiling.



3

Using the nuts, fix the right front ceiling to the right top wall.

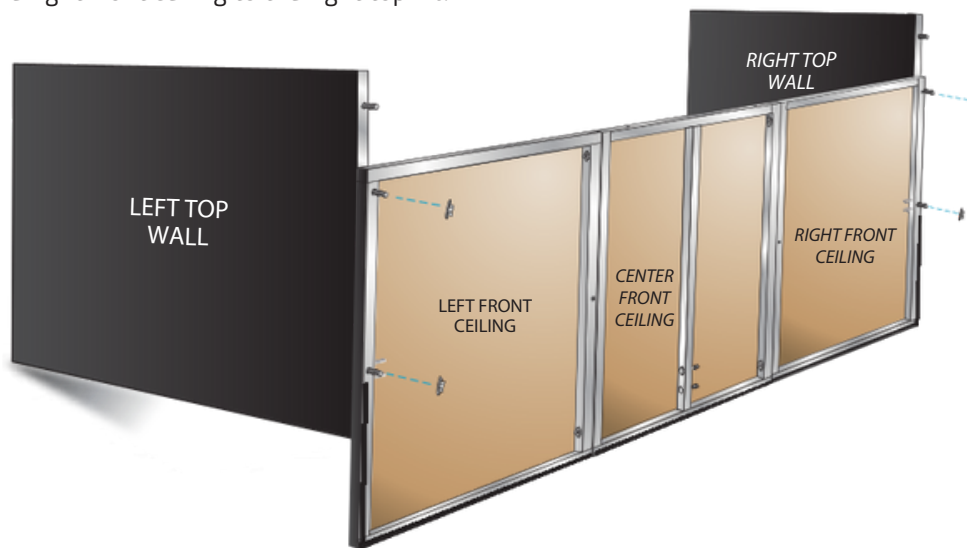

4

Fix both bottom wall panels to the top wall panels with the nuts by removing the bottom wall covers (velcro).

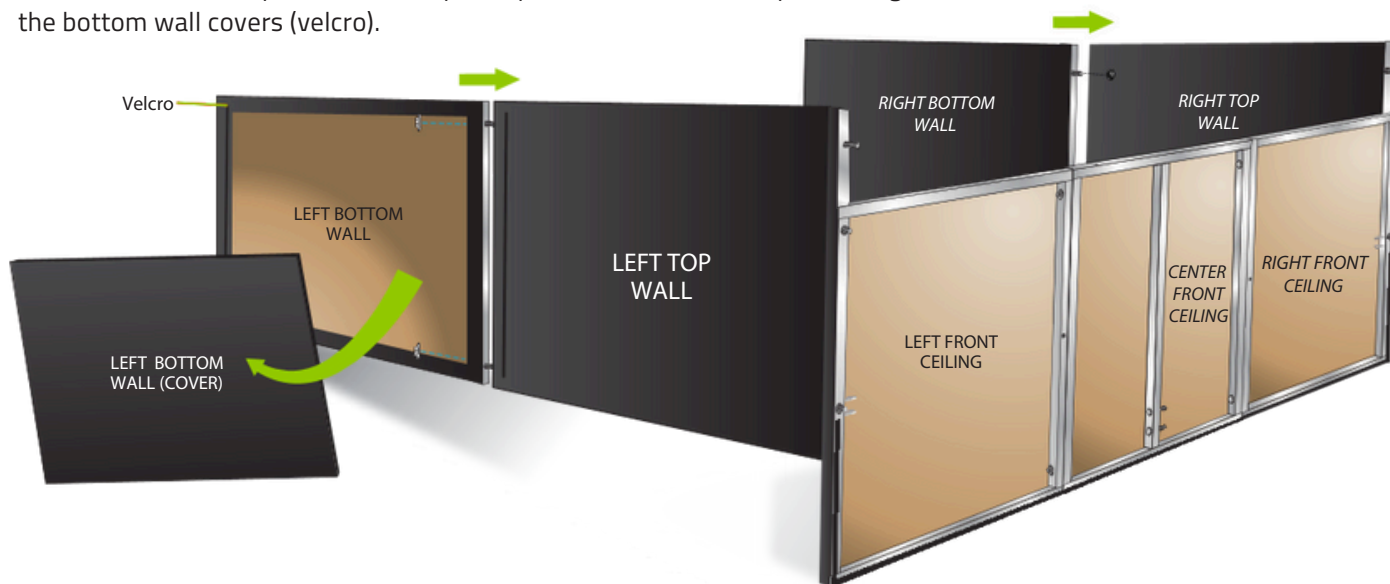

**5**

Fix the left back ceiling to the left top wall with the nuts.

**6**

Using the nuts, fix the center back ceiling to the left back ceiling and fix the two center ceilings together.

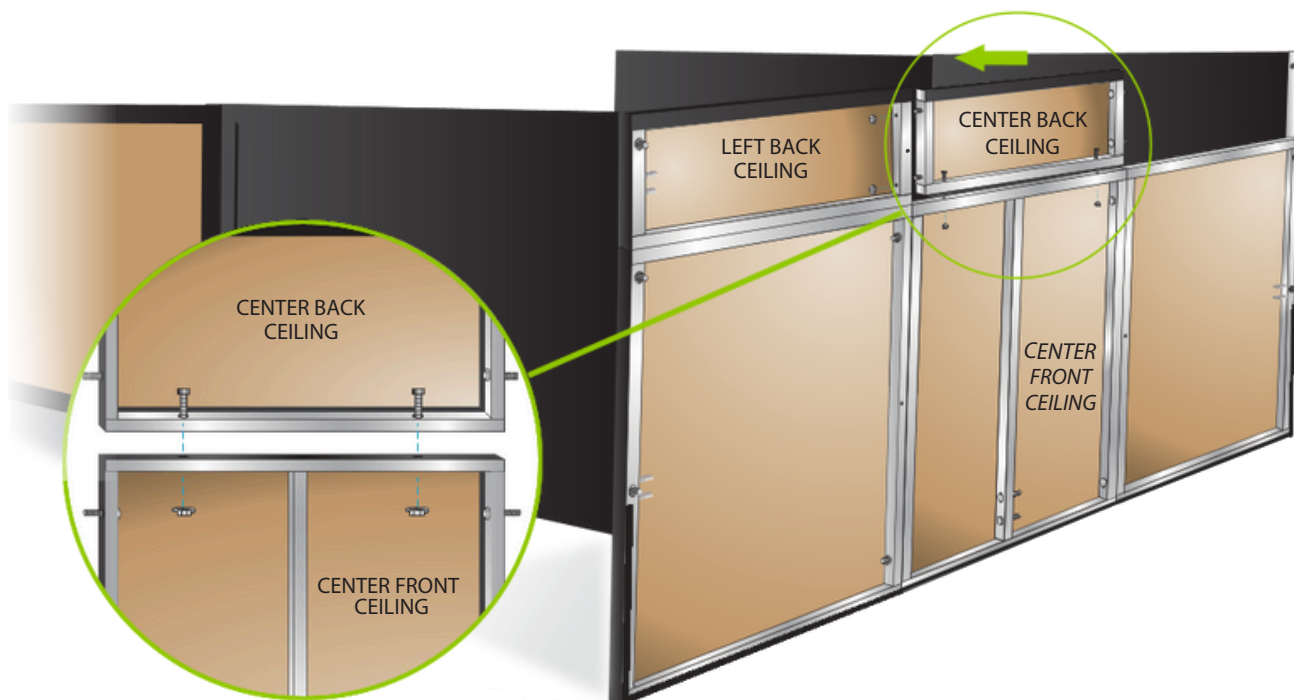

7

Fix the right back ceiling to the center back ceiling and to the right top wall with the nuts.



8

**CEILING TRUSS INSTALLATION**

Assemble the ceiling trusses with bolts and security pins, then insert them in the back ceiling and the front ceiling.

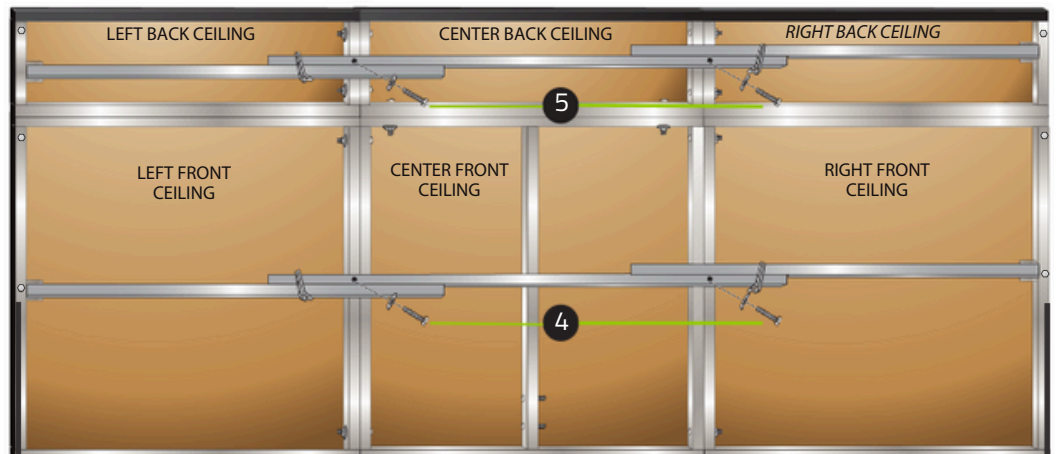
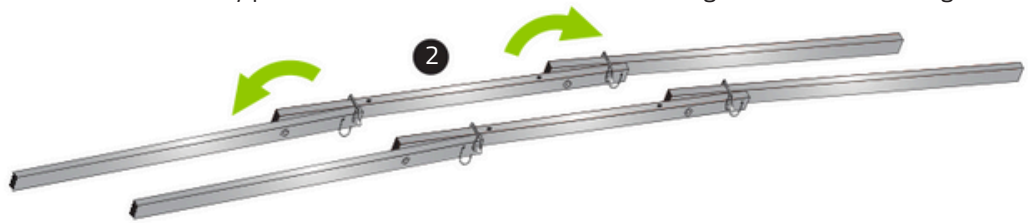
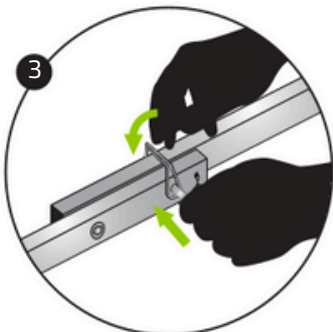
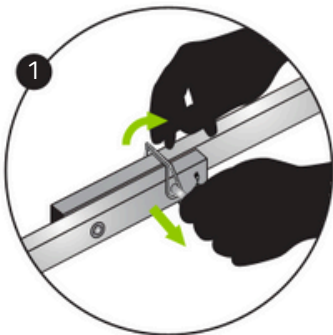

**IT IS IMPORTANT TO COMPLETE THIS STEP BEFORE LIFTING THE STRUCTURE.**



**9**

Attach the white screen to the structure.

**10**

Attach the black netting over the white screen. Make sure it is attached to the top velcro on the ceiling panels and that the bottom doesn't rest on the floor.

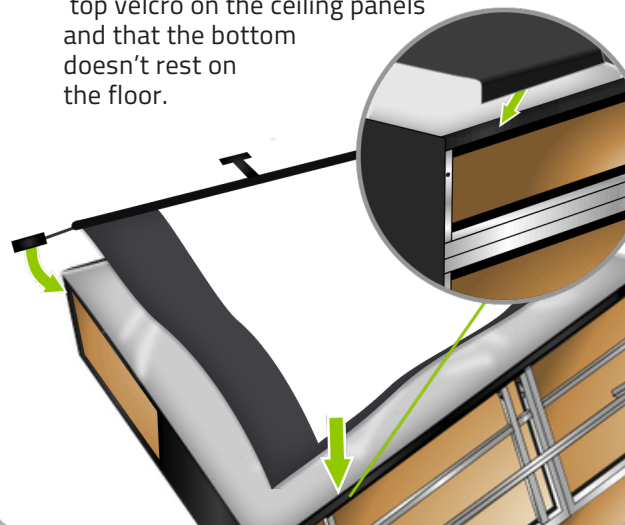
**11**

Lift the structure with four people.



END OF STRUCTURE INSTALLATION SECTION

1

Install the floor sections in order (1 to 6). A and B you will need bolts washers and nuts. C you will need washers and nuts.

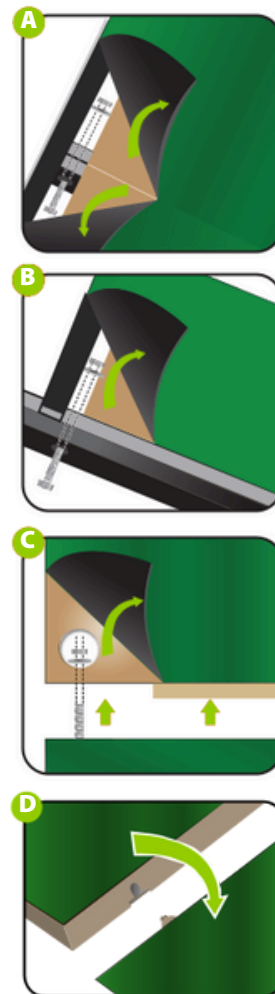
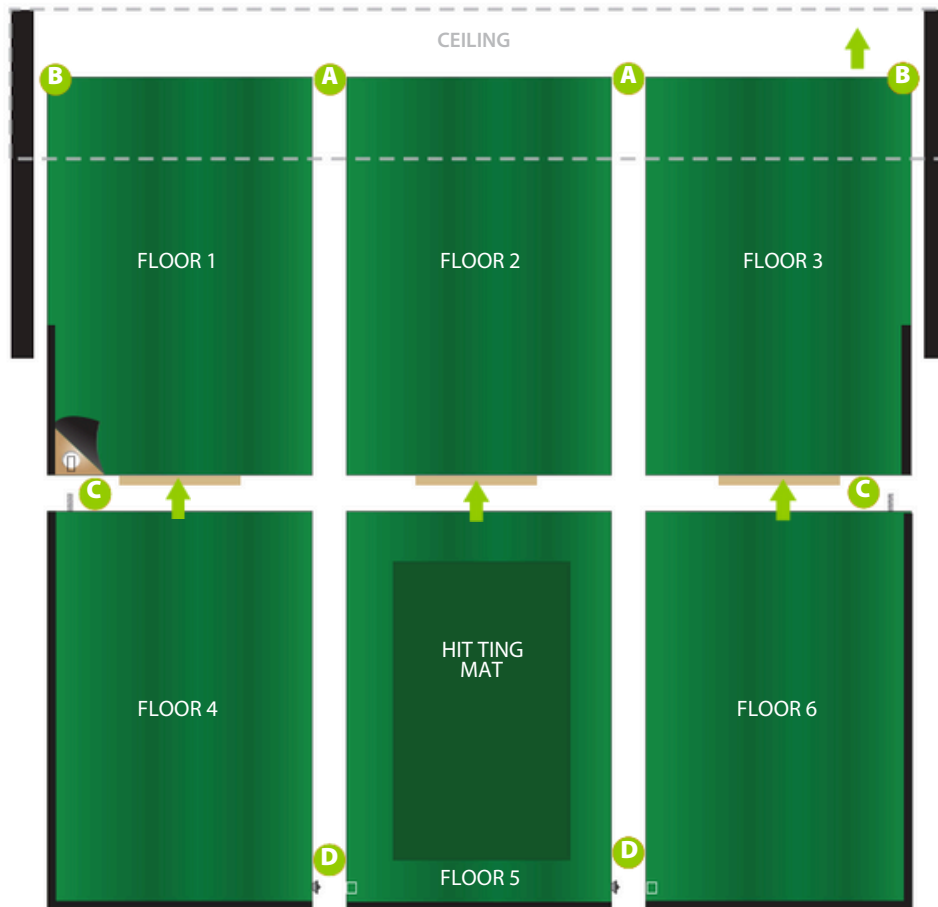

2

**Step 1**

Lift green carpet.

**Step 2**

Stretch the white screen behind and under the aluminum bar and reach for it through the space.

**Step 3**

Fix the screen on half of the velcro on the aluminum bar.

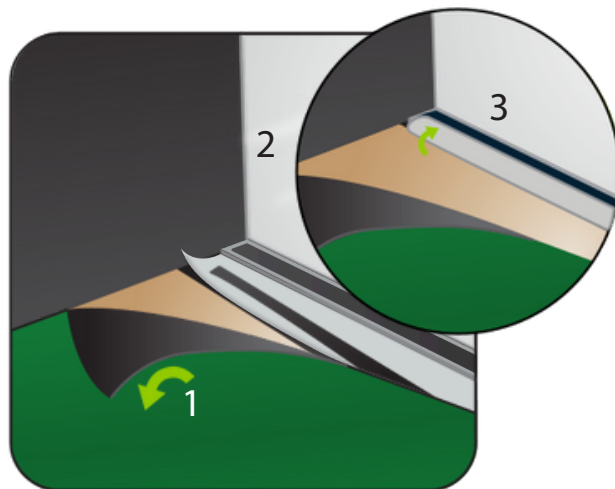

3

**Step 1**

Lift green carpet.

**Step 2**

Stretch the white screen behind and under the aluminum bar and reach for it through the space.

**Step 3**

Stick it on the remaining half of the aluminum bar velcro.

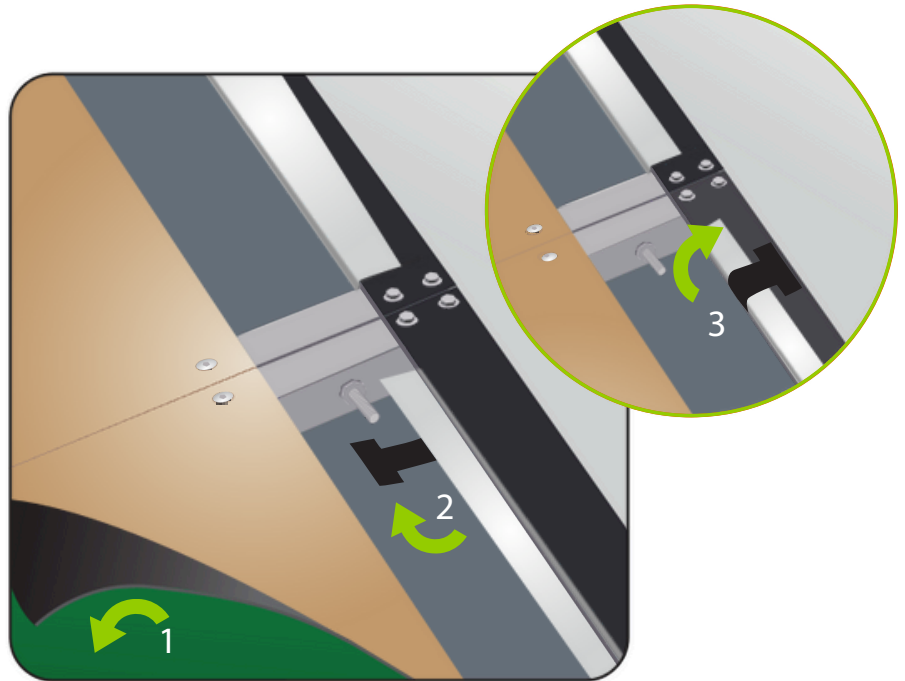

END OF STRUCTURE FLOOR INSTALLATION SECTION

**HALF WALLS INSTALLATION**

Fix the half-walls to the structure with washers and nuts. Then, install the removable panel on the bottom walls with the velcro.



1

### PROJECTOR BEAM INSTALLATION

Attach the projector beam to the ceiling structure with washers and nuts.

\*If installed on the ceiling, refer to Appendix A for the right position.

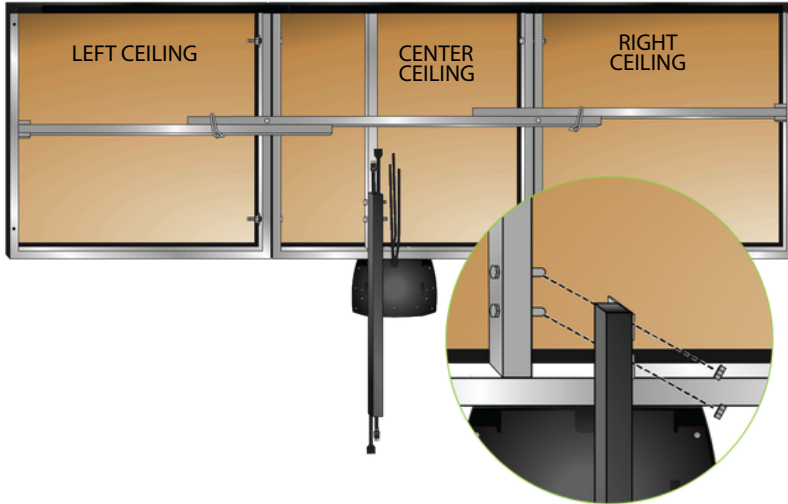

2

### PROJECTOR INSTALLATION

Attach the projector on the projector mount. Refer to the instruction sheet inside the projector box.

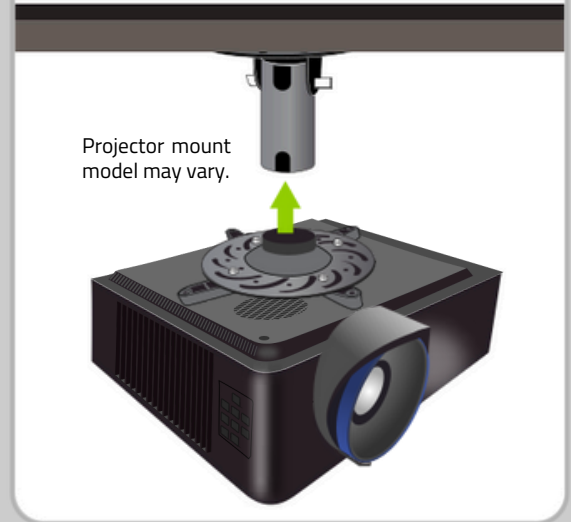

3

### PROJECTOR CABLE CONNECTIONS

Plug the HDMI cable to the HDMI port on your projector and on your PC. Connect the power cable to the ground terminal and your electrical outlet. Refer to Appendix B for your projector adjustments.

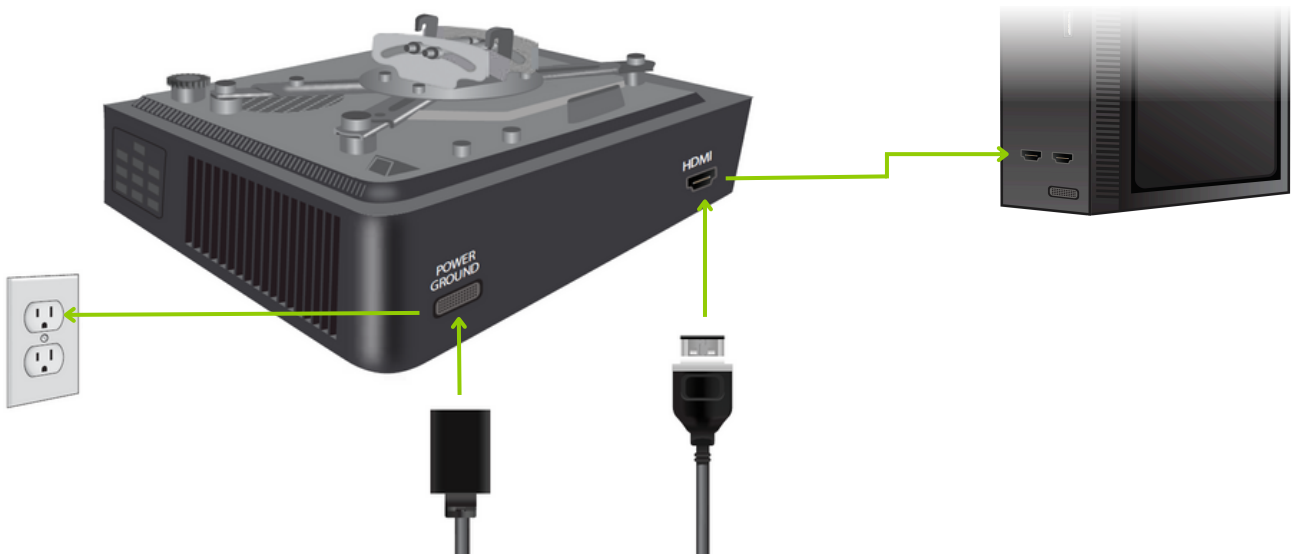

## WIRE COVER

Stick one side of the wire cover to the structure using the Velcro. Gather your wires inside the wire cover and, forming a loop over the wires, stick the second side of the wire cover just in front of your first Velcro.

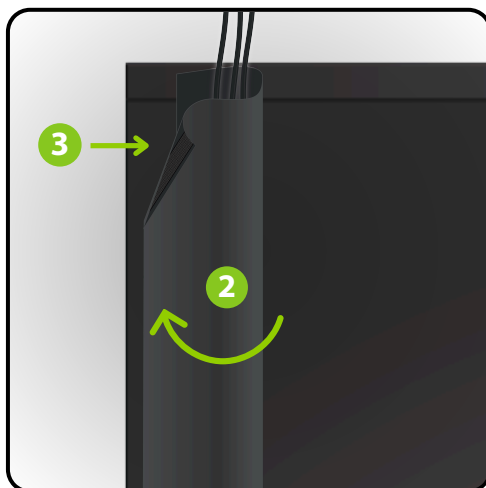
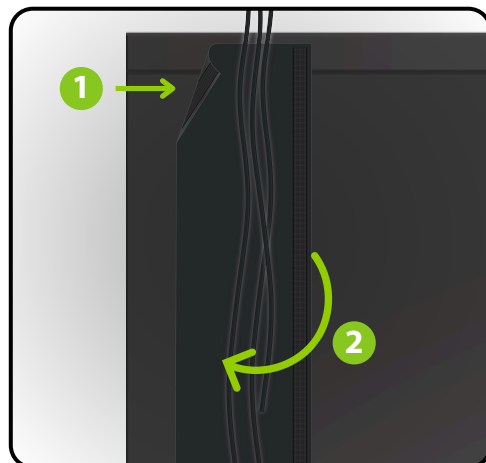
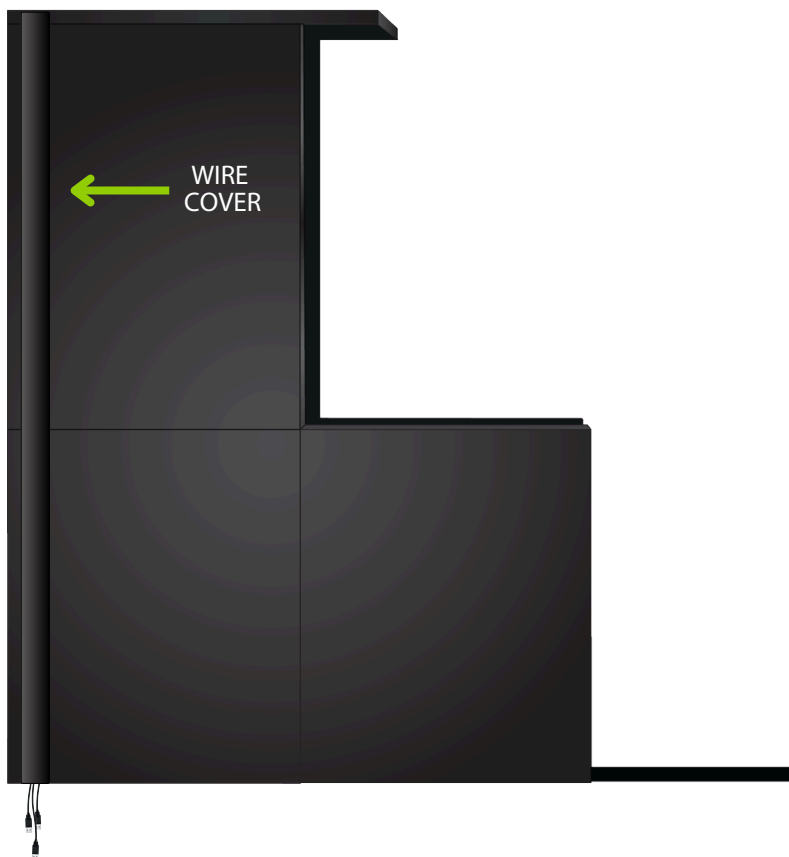

### PROJECTOR POSITION WITHOUT PROJECTOR BEAM

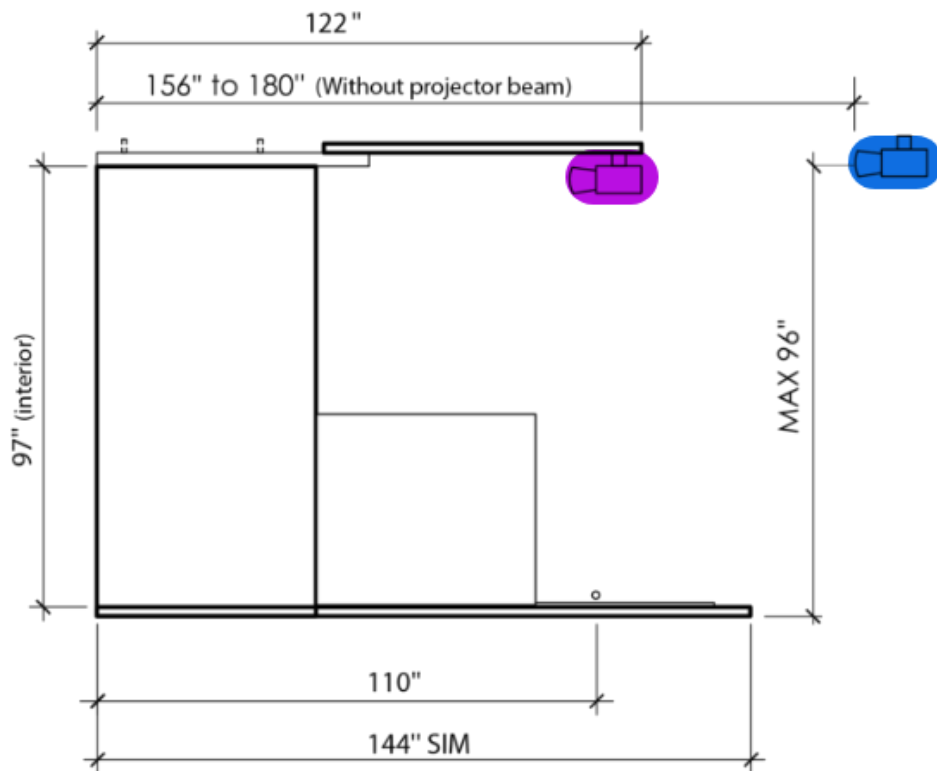

# BENQ LH600ST PROJECTOR AJUSTEMENTS

## TABLE OF CONTENTS

- |  |  |
|--|--|
| 1. Select the correct HDMI Source                    | 5. Display / Aspect Ratio / 16:10                    |
| 2. System / Language                                 | 6. Display / Image Resize / Digital Shrink and Shift |
| 3. Settings / Projector Installation / Front Ceiling | 7. Display / Corner fit                              |
| 4. Picture / Golf                                    | 8. Zoom and Focus                                    |

## 1. SELECT THE CORRECT HDMI SOURCE

### STEP 1

Turn on the projector and press the 'Source' button on the remote control.

### STEP 2

Use the arrows to navigate to the appropriate HDMI input (HDMI 1 or HDMI 2) and press 'OK' to select.

## 2. SYSTEM / LANGUAGE

### STEP 1

Press the 'Menu' button on the remote control.

### STEP 2

Go to 'System' then 'Language'.

### STEP 3

Select the desired language for the projector interface.

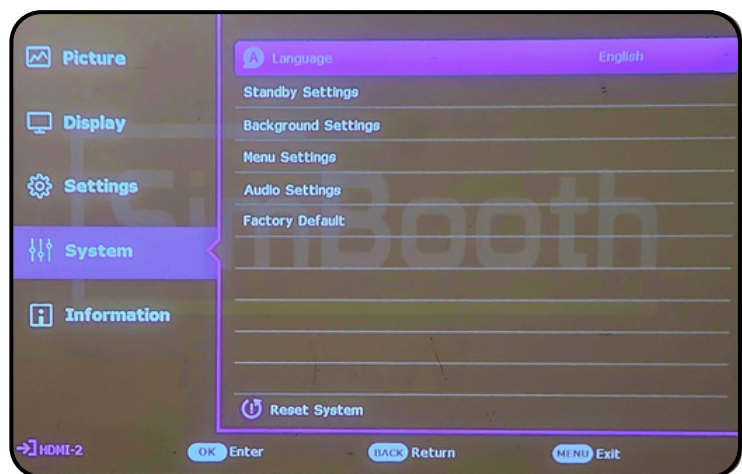

### 3. SETTINGS / PROJECTOR INSTALLATION / FRONT CEILING

**STEP 1**

Press the 'Menu' button on the remote control.

**STEP 2**

Go to 'Settings'.

**STEP 3**

Select 'Projector Installation' and set it to 'Front Ceiling'.

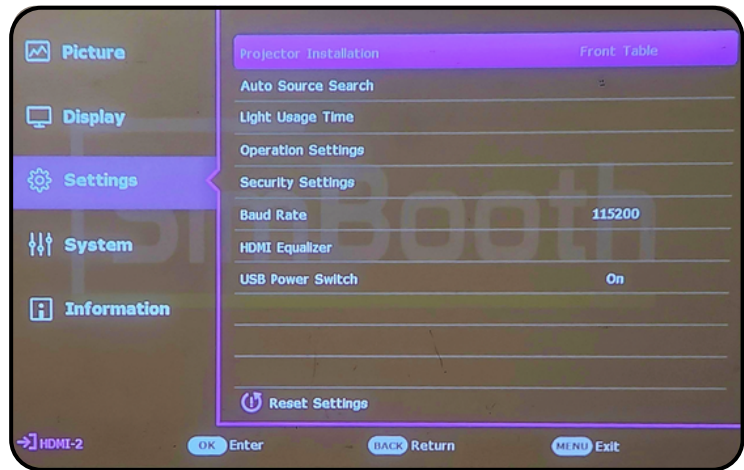

### 4. PICTURE / GOLF

**STEP 1**

Press the 'Menu' button on the remote control.

**STEP 2**

Go to 'Picture' then select the 'Golf' mode in 'Picture mode'

**This mode optimizes colors for golf simulators, making greens and blues more vivid.**

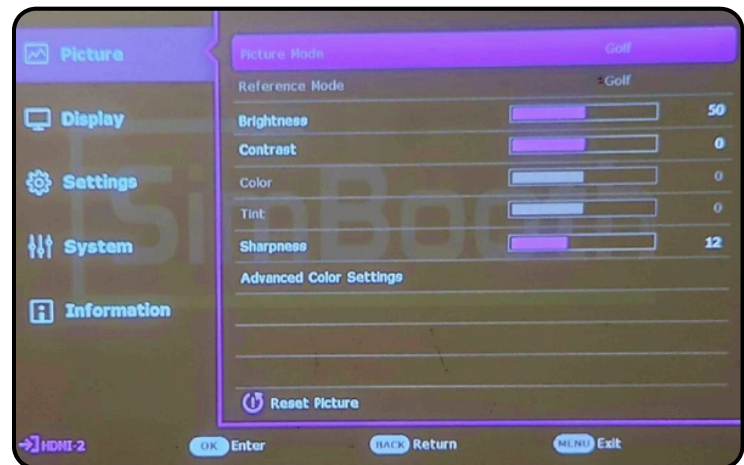



## 5. DISPLAY / ASPECT RATIO / 16:10

### STEP 1

Press the 'Menu' button on the remote control.

### STEP 2

Go to 'Display' then 'Aspect Ratio'.

### STEP 3

Select the '16:10' format to adjust the image to this ratio.

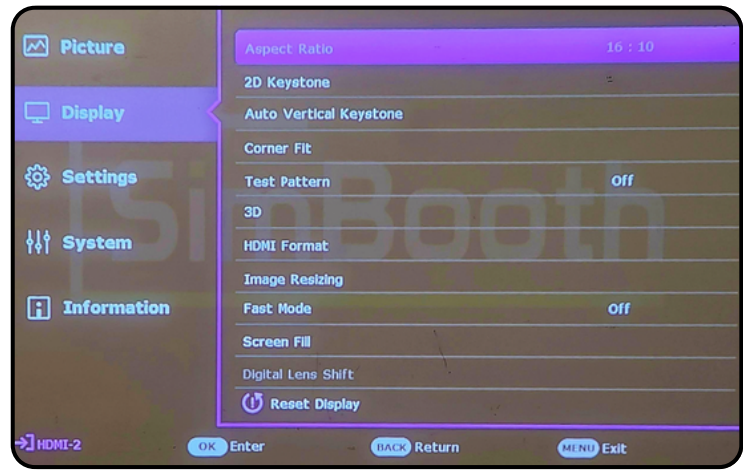

## 6. DISPLAY / IMAGE RESIZE / DIGITAL SHRINK AND SHIFT

### STEP 1

Press the 'Menu' button on the remote control.

### STEP 2

Go to 'Display' then 'Image Resize'.

### STEP 3

Select 'Digital Shrink and Shift' to adjust the size and position of the projected image.

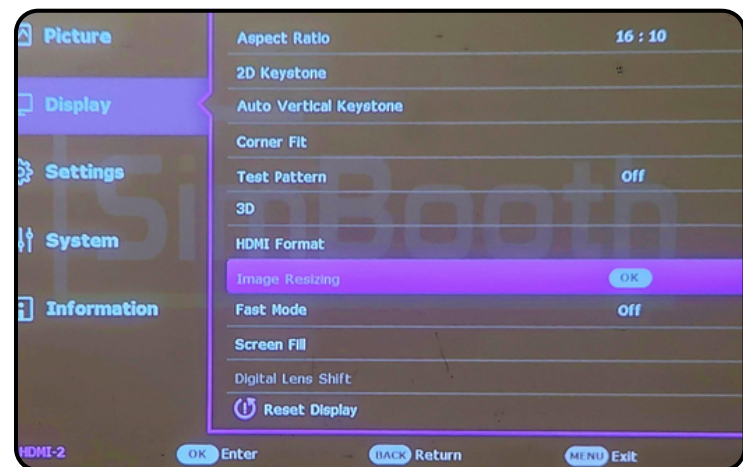

## 7. DISPLAY / CORNER FIT

### STEP 1

Press the 'Menu' button on the remote control.

### STEP 2

Go to 'Display' then 'Corner Fit'.

### STEP 3

Use the arrows to adjust each corner of the image to correct any distortion and achieve a perfectly aligned image.

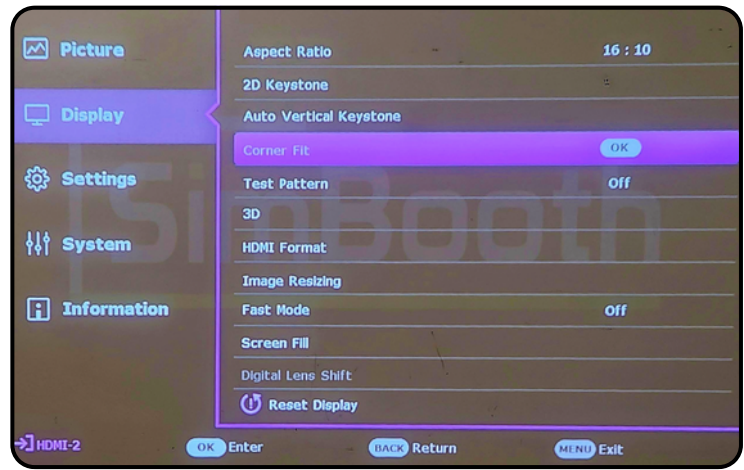

## 8. ZOOM AND FOCUS

### ZOOM

Turn the zoom ring on top of the lens to adjust the size of the projected image.



### FOCUS

Use the focus ring, also located on top of the lens, to adjust the sharpness of the image. Turn the ring until the image is clear and sharp.

