



INSTALLATION GUIDE
SIMBOOTH 2

TABLE OF CONTENTS

INSTALLATION

Part list	3-5
Structure assembly	6-10
Floor installation	11-12
Options Installation	13-14



PARTS LIST

WALL PANELS

RIGHT WALL

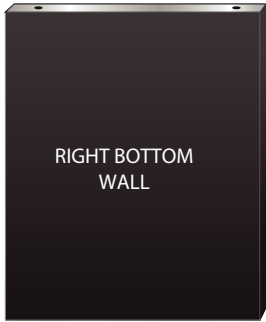
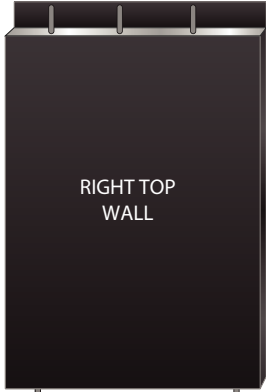

LEFT WALL

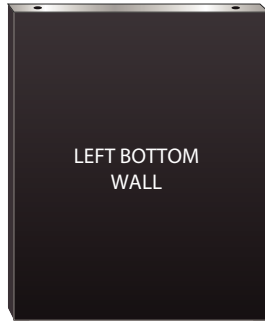
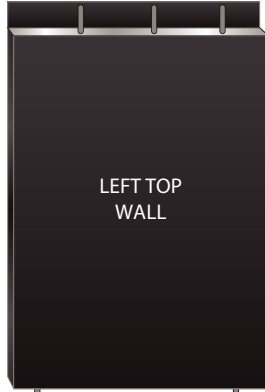

CEILING PANELS

BACK CEILING

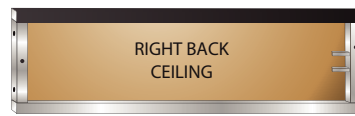

FRONT CEILING



FLOOR PANELS

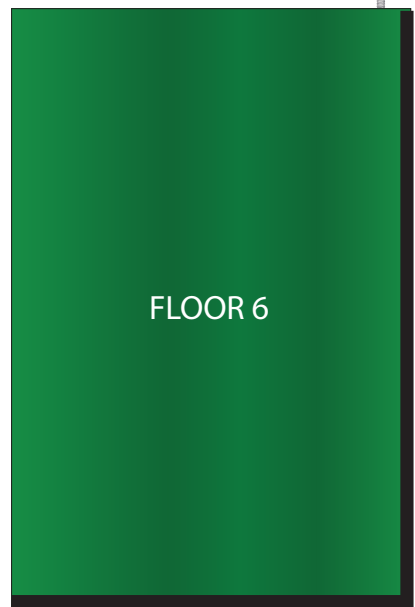
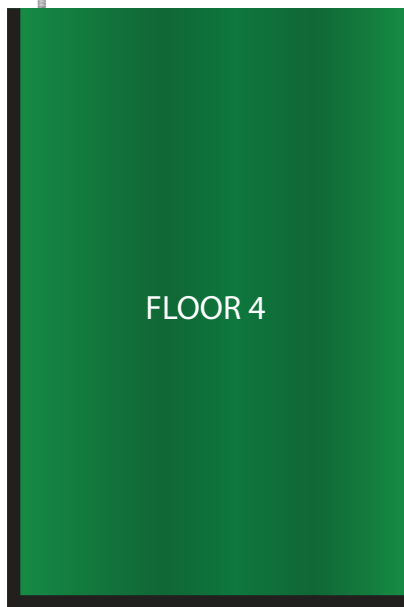
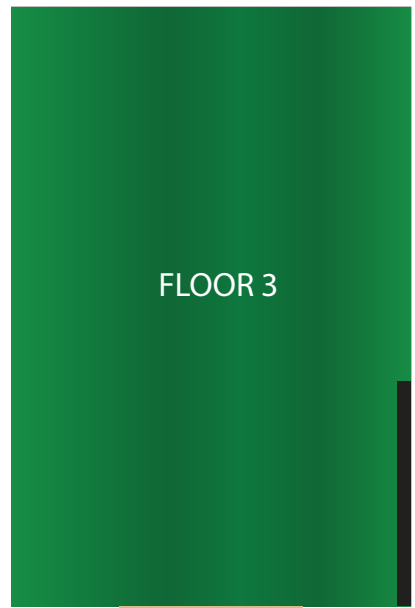
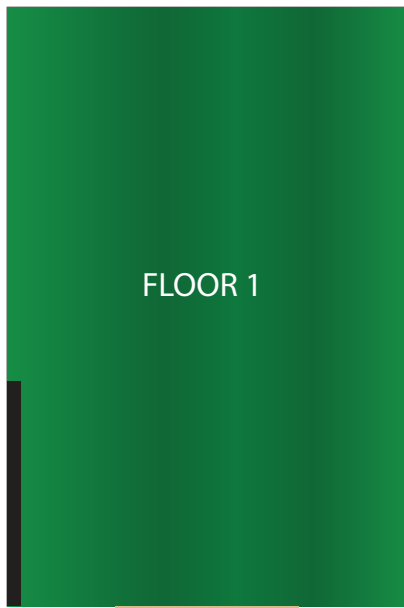

PARTS LIST

ACCESSORIES

Hitting mat



Bolts



3-1/2" (40x)

Washers (52 X)



Nuts (40 X)



Shime

(Under the hitting mat)



White screen

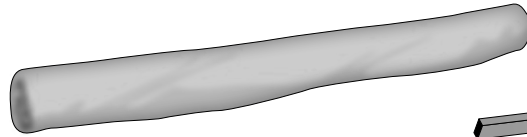

Ceiling trusses (2x)

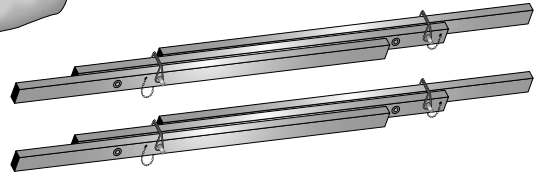

Shime

(Under the hitting mat)



Black impact netting



Tees (10x)



OPTIONAL

Half wall (2x)

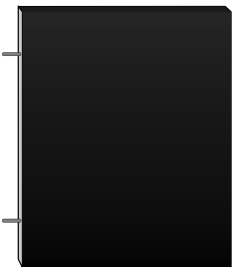

Projector and remote



Rafter



BEFORE STARTING

You will need 4 people, 2 ladders, a screwdriver and 1/2 wrench.



1

Fix the left top wall to the left front ceiling with the nuts.

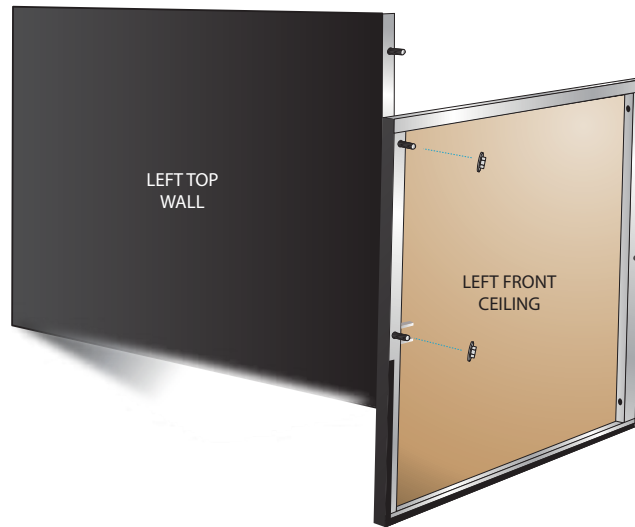

2

Using the nuts, fix the middle front ceiling to the left front ceiling, then fix right front ceiling to the middle front ceiling.



3

Using the nuts, fix the right front ceiling to the right top wall.

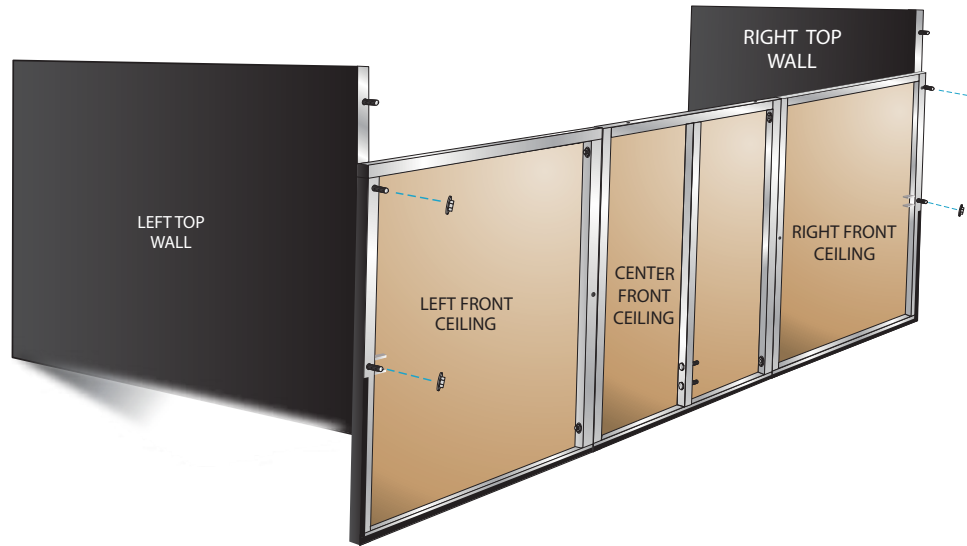
**4**

Fix both bottom wall panels to the top wall panels with the nuts by removing the bottom wall covers (velcro).



5

Fix the left back ceiling to the left top wall with the nuts.



6

Using the nuts, fix the center back ceiling to the left back ceiling and fix the two center ceilings together.

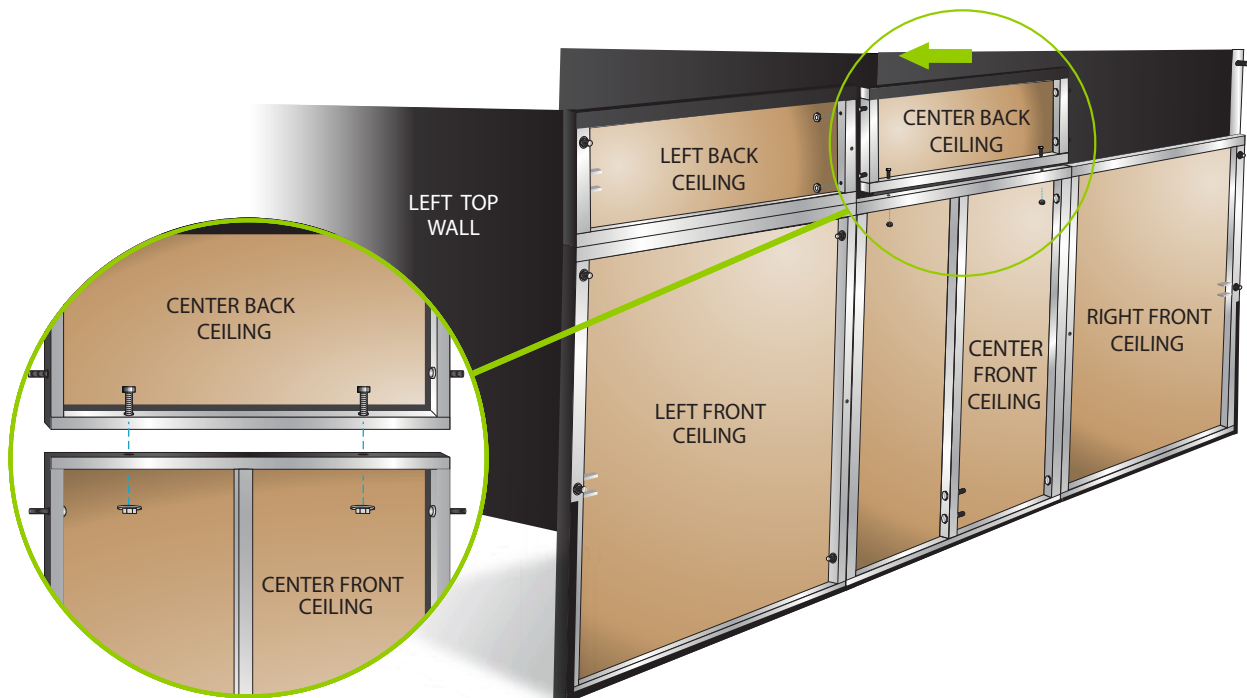

7

Fix the right back ceiling to the center back ceiling and to the right top wall with the nuts.

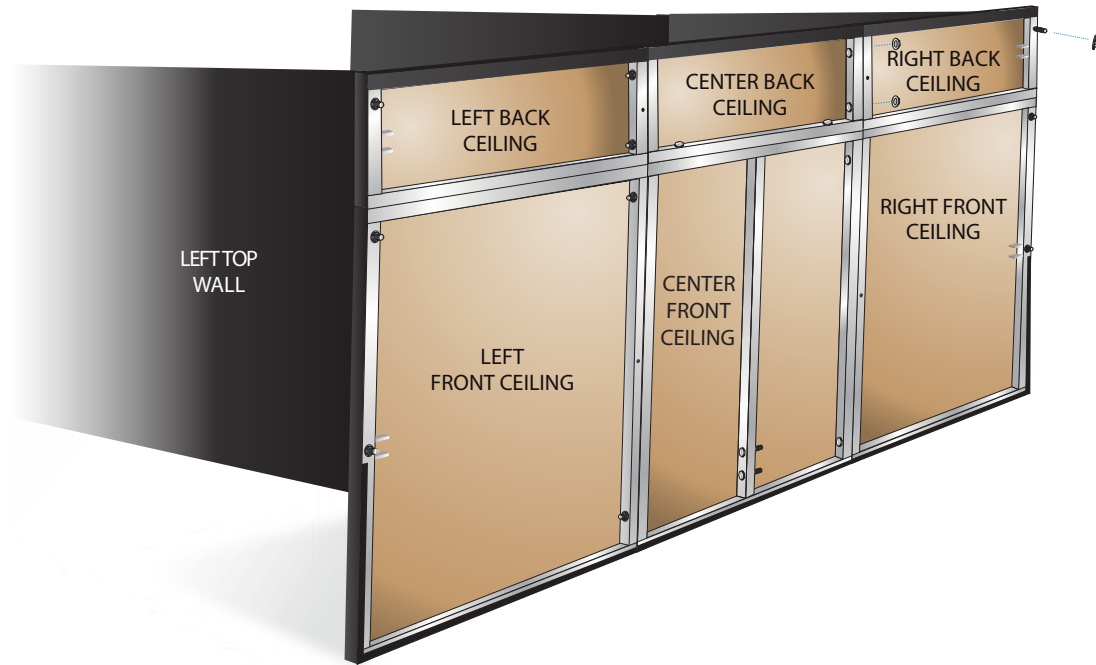

8

CEILING TRUSS INSTALLATION

Assemble the ceiling trusses with bolts and security pins, then insert them in the back ceiling and the front ceiling.

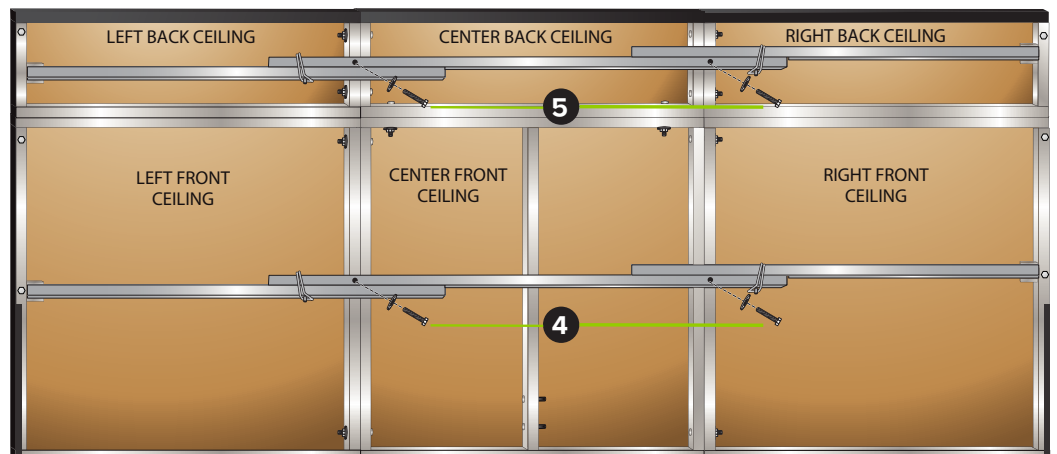
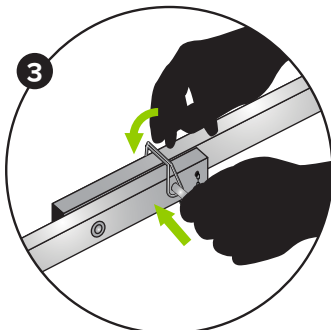
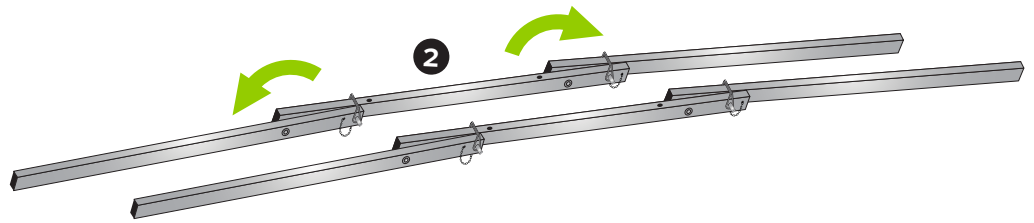
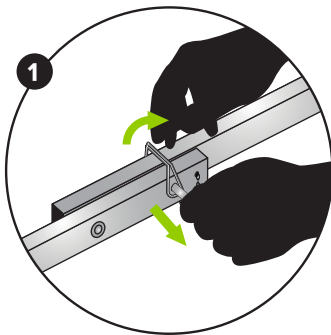

IT IS IMPORTANT TO COMPLETE THIS STEP BEFORE LIFTING THE STRUCTURE.

9

Attach the white screen to the structure.



10

Attach the black netting over the white screen. Make sure it is attached to the top velcro on the ceiling panels and that the bottom doesn't rest on the floor.

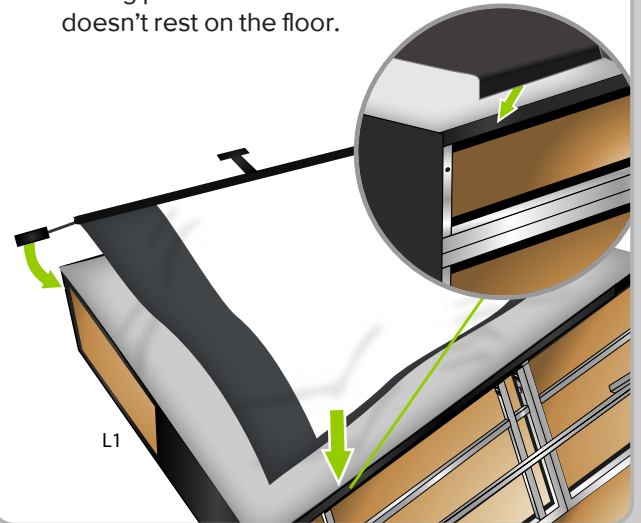

11

Lift the structure with four people.

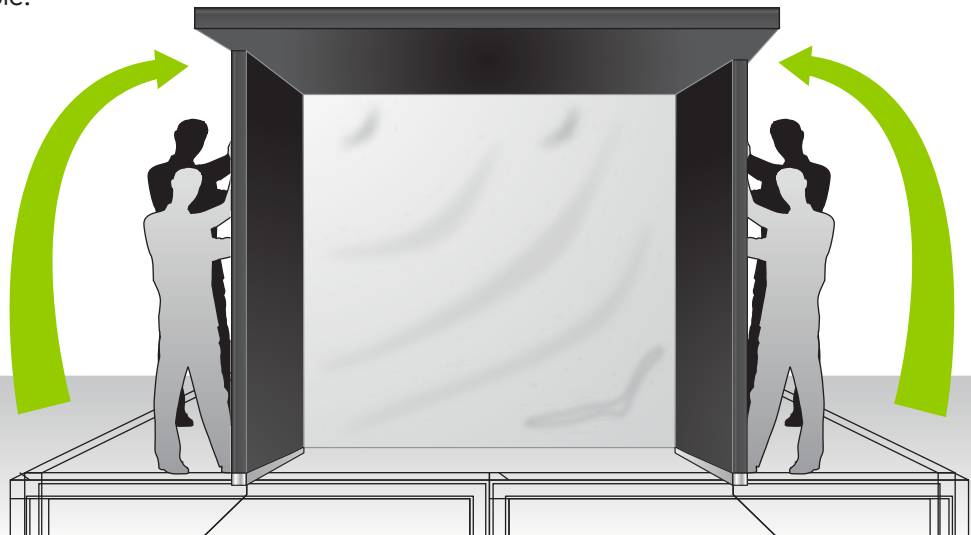

END OF STRUCTURE ASSEMBLY SECTION

1

Install the floor sections in order (1 to 6).

A and **B** you will need bolts washers and nuts. **C** you will need washers and nuts.

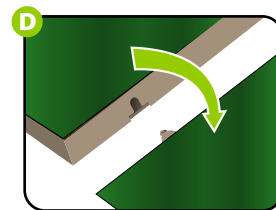
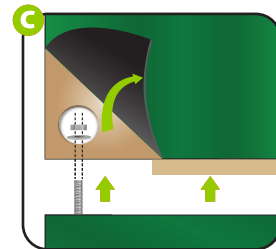
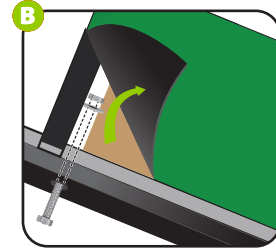
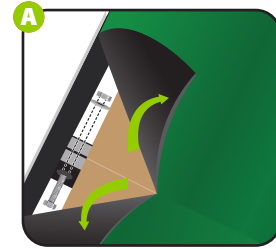
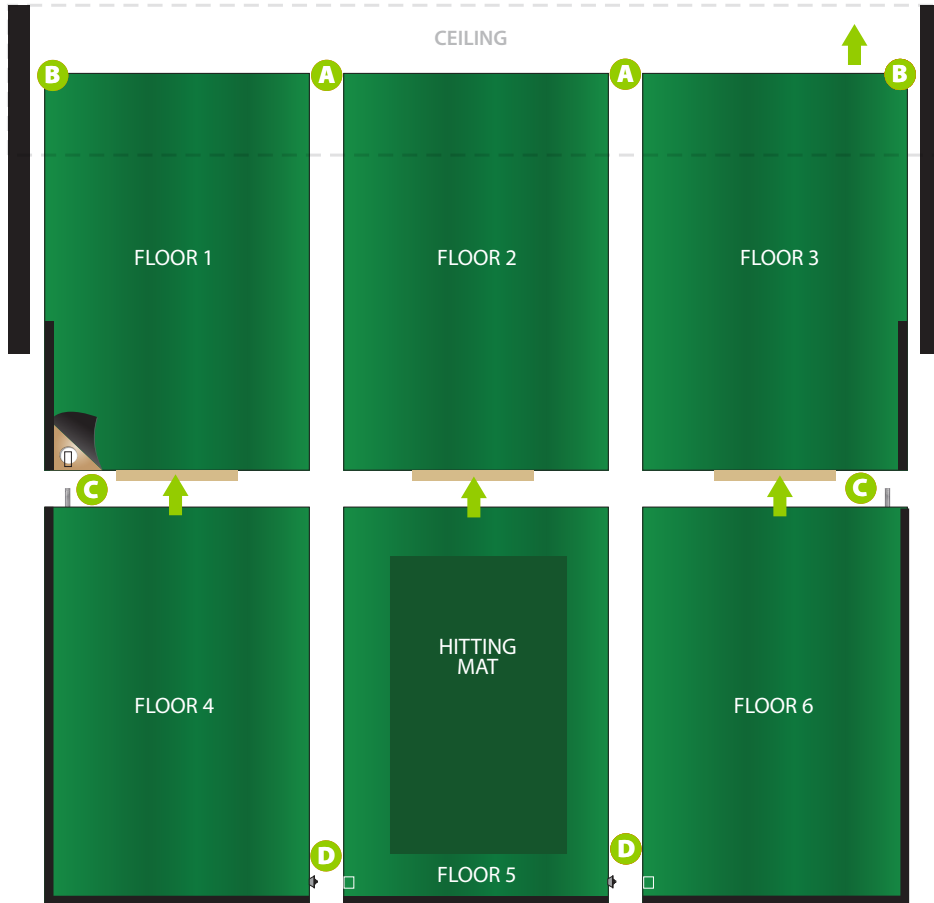

2

Step 1

Lift green carpet.

Step 2

Stretch the white screen behind and under the aluminum bar and reach for it through the space.

Step 3

Fix the screen on half of the velcro on the aluminum bar.

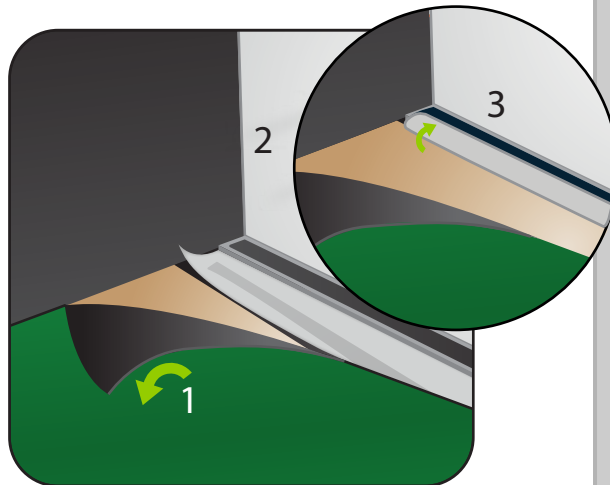

3

Step 1

Lift green carpet.

Step 2

Stretch the white screen behind and under the aluminum bar and reach for it through the space.

Step 3

Stick it on the remaining half of the aluminum bar velcro.

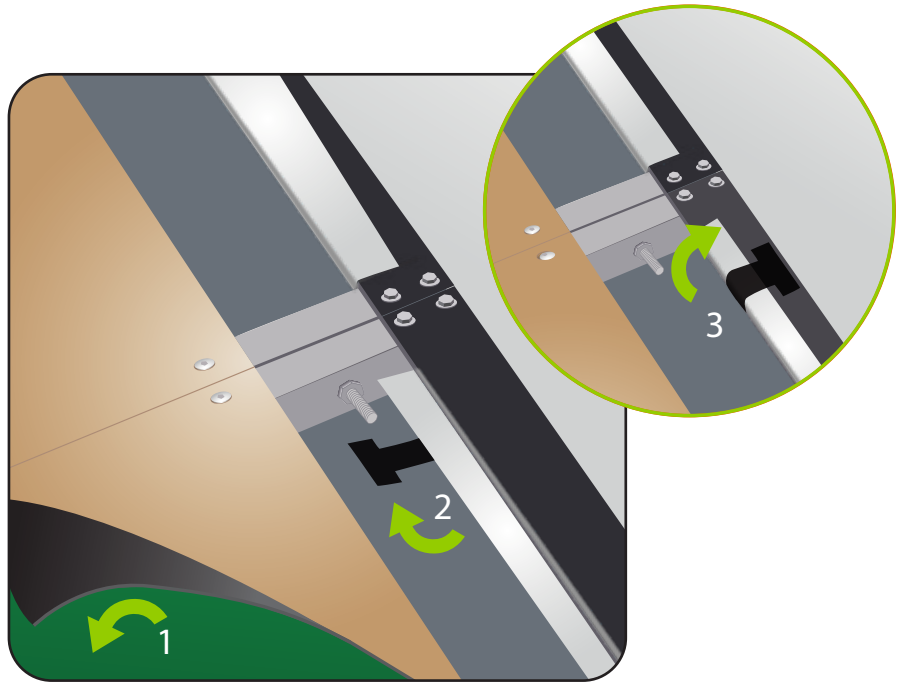

END OF FLOOR INSTALLATION SECTION

1

Fix the half-walls to the structure with washers and nuts. Then, install the removable panel on the bottom walls with the velcro.

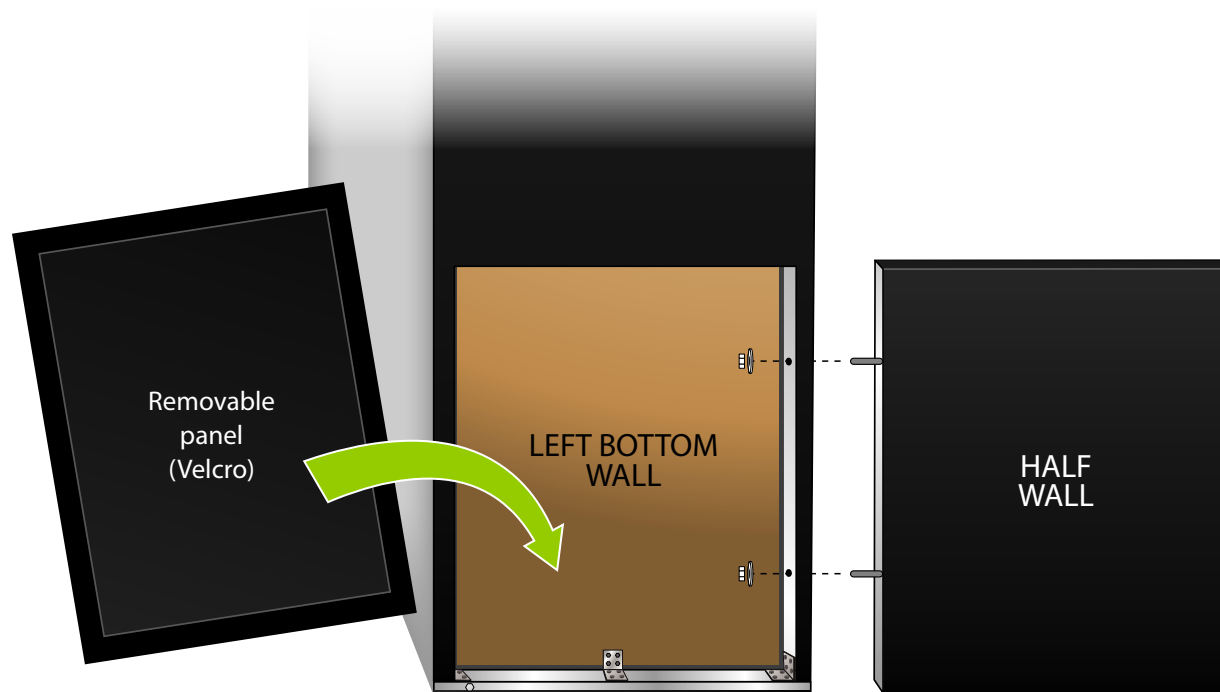

2**RAFTER INSTALLATION**

Attach the rafter to the ceiling structure with washers and nuts.

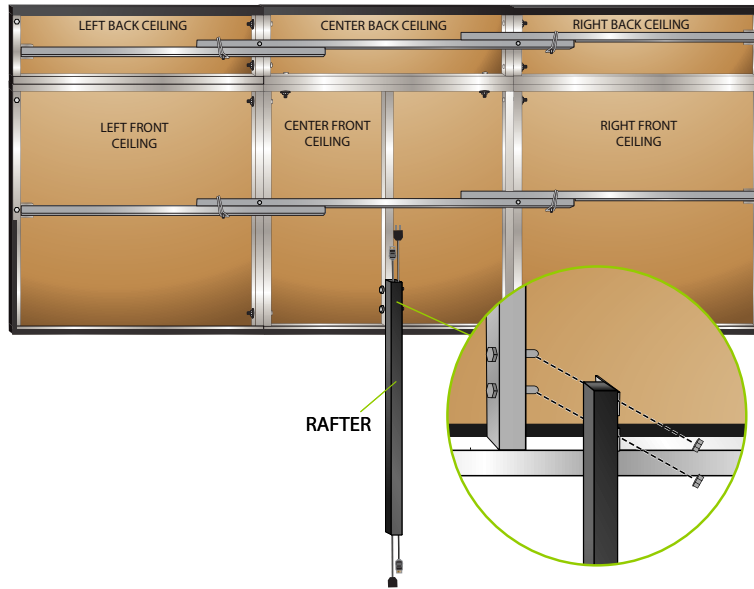
**3****PROJECTOR INSTALLATION**

Attach the projector on the projector mount. Refer to the instruction sheet inside the projector box.

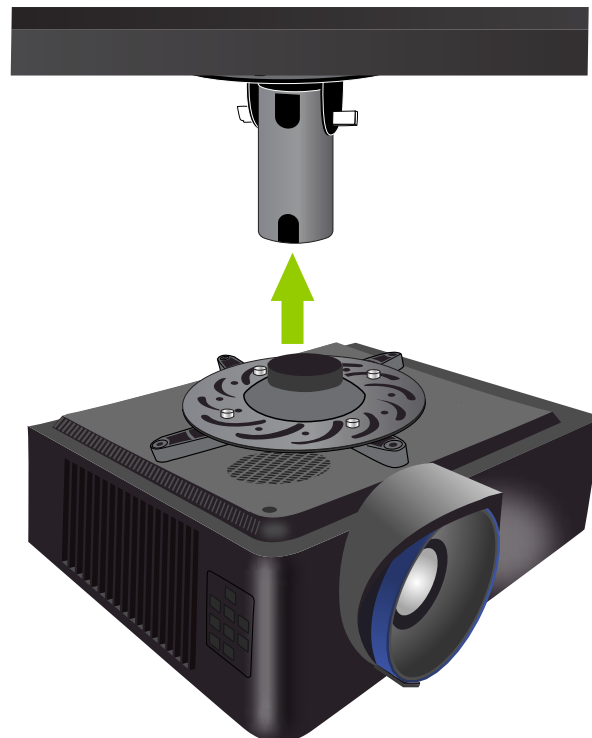

Projector mount
model may vary.

END OF OPTIONS INSTALLATION